

KNOCK DOWN LEAF BOX ASSEMBLY GUIDE





BEGINNING THE ASSEMBLY: This is a 2-person assembly and takes approx. 2.5 hours to complete

TOOLS YOU WILL NEED: • 1/2" wrench • 1/2" socket • Impact • 1 1/2" wrench or adjustable wrench
• optional line up bar • hardware is included

If you have any questions, check out our Knock Down Leaf Box Assembly Guide on YouTube, or contact our Customer Service Department on (800) 851-9664.



Choose a suitable location to assemble the leaf box. Work area should be level with a smooth concrete floor for best results.



Open the shipping crate and remove all components, sorting like components together.



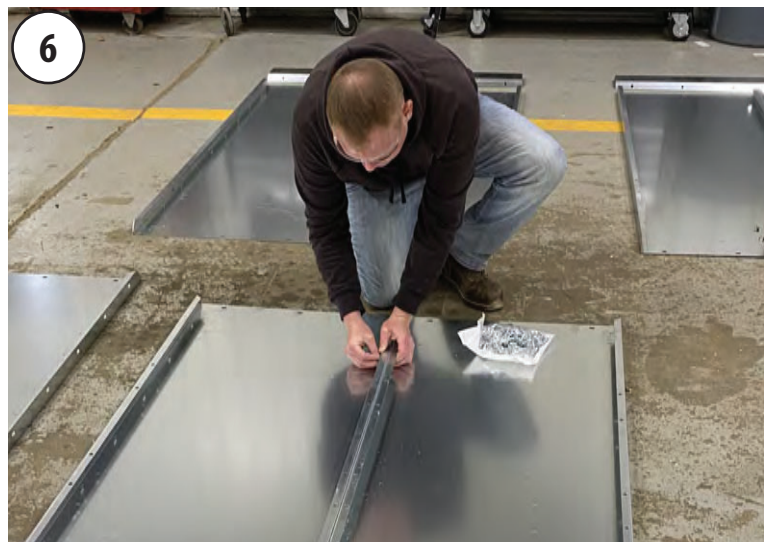
Locate the (2) front panels and lay them side by side with the flanges up.



Bolt the front panels together with (9) 5/16"- 18 x 1" flange screws and 5/16"-18 locknuts.



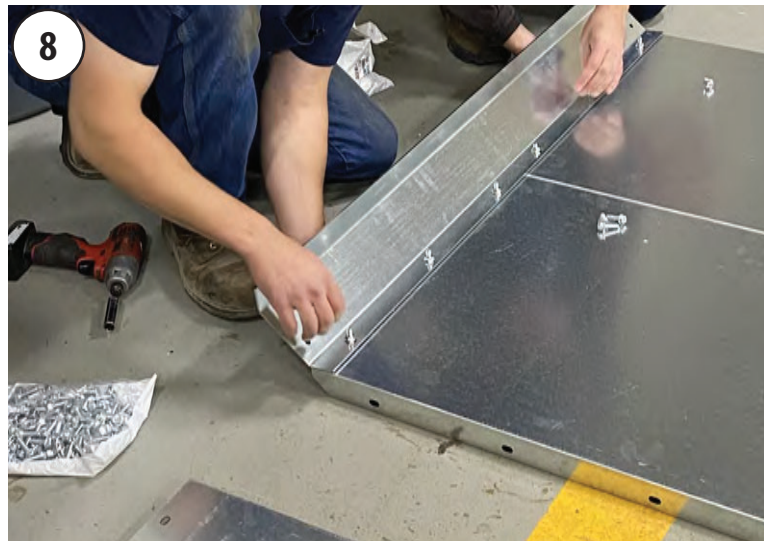
5 Bolt the front channel to the front panels with (8) 5/16"-18 x 1" flange screws and 5/16"-18 locknuts.



6 Locate (2) side panels and lay them side by side with the flanges up.



7 Bolt the side panels together with (9) 5/16"-18 x 1" flange screws & 5/16"-18 locknuts.



8 Bolt a floor channel to the side panels with (6) 5/16"-18 x 1" flange screws & 5/16"-18 locknuts.



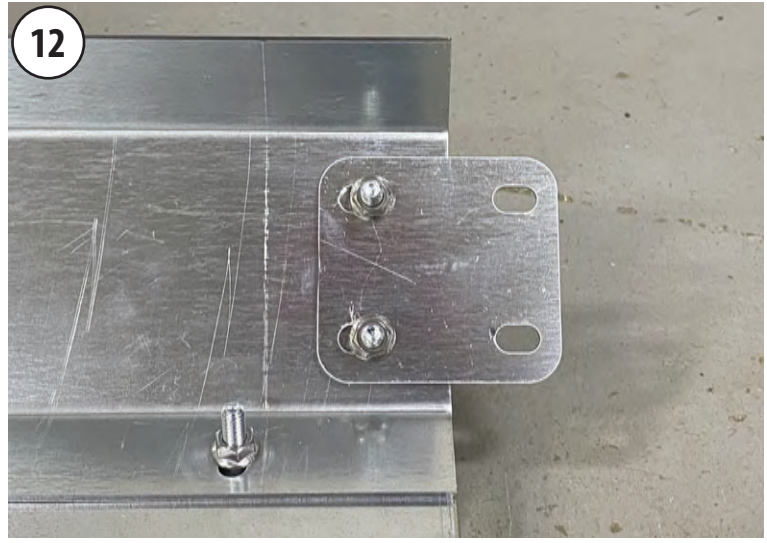
9 Repeat steps 6 - 8 for the remaining sets of side panels.



10 Stand up the front panel assembly and bolt one side panel assembly to each end with (11) 5/16"-18 x 1" flange screws & 5/16"-18 locknuts.



Install (2) top panels with (14) 5/16"-18 x 1" flange screws & 5/16"-18 locknuts each.



Install (1) floor connector plate to the end of each floor channel with (2) 5/16"-18 x 1" flange screws & 5/16"-18 locknuts each.



Repeat steps 6 - 12 for the remaining side & top panels. Note: The last side panels will bolt to the floor plate instead of a floor channel.



Bolt the tailgate support channels to the side panels & floor plate with (11) 5/16"-18 x 1" flange screws & 5/16"-18 locknuts each.



Bolt the tailgate hinge support to the tailgate support channels & top panel with (12) 5/16"-18 x 1" flange screws & 5/16"-18 locknuts.



Assemble (1) 1"-8 x 4-1/2" bolt & (2) 1"-8 hex nuts to each tailgate support channel.

17



Install side reinforcements on the side panels with 5/16"-18 x 1" flange screws & 5/16"-18 locknuts. The short & long side reinforcements should be staggered for added strength.

18



Assemble the tailgate by bolting (1) tailgate end panel & (1) rear vertical stiffener to each side of the tailgate center panel with (9) 5/16"-18 x 1" flange screws & 5/16"-18 locknuts.

19



Bolt the tailgate hinge angle to the inside of the tailgate assembly with (9) 5/16"-18 x 1" flange screws & 5/16"-18 locknuts.

20



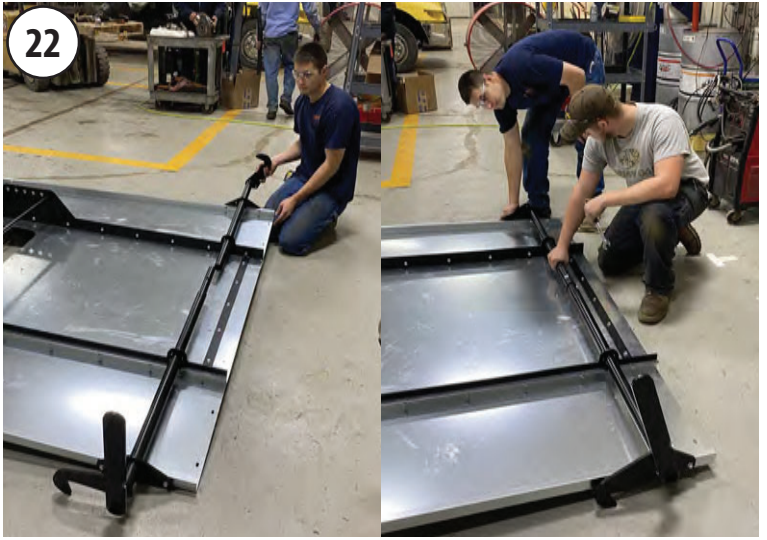
Bolt on the (2) tailgate center supports with (5) 5/16"-18 x 1" flange screws & 5/16"-18 locknuts each.

21



Assemble the tailgate latch by bolting (1) trip arm mount to each side of the tailgate assembly with (2) 5/16"-18 x 1" flange screws & 5/16"-18 locknuts.

22



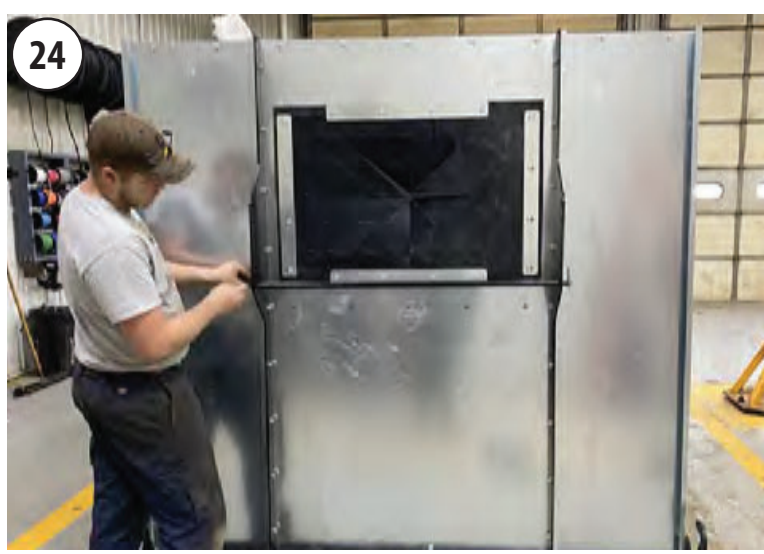
Insert the left & right trip arms through the trip arm mounts and connect with the 3/8"-16 x 2-1/2" bolt & 3/8"-16 locknut.

23



Assemble the rubber insert and (4) retainer strips with (16) 5/16"-18 x 1" flange screws & 5/16"-18 locknuts.

24



Assemble the hose support to the tailgate and secure with hair pins.

25



Assemble the tailgate assembly to the leaf box with (3) 1" x 2" clevis pins and hairpins.

26



Close the latch and insert the snapper pin to lock.

27



Apply the safety decals to the tailgate.

28



Leaf box is now ready for installation on a truck.

Titan LEAF™ CAP

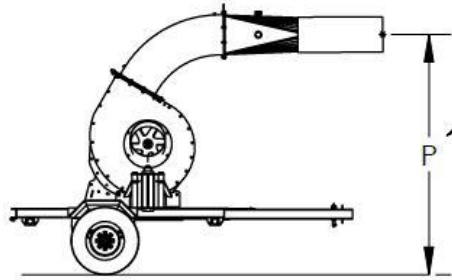
INSTALLATION AND OPERATION MANUAL.

REV 090920

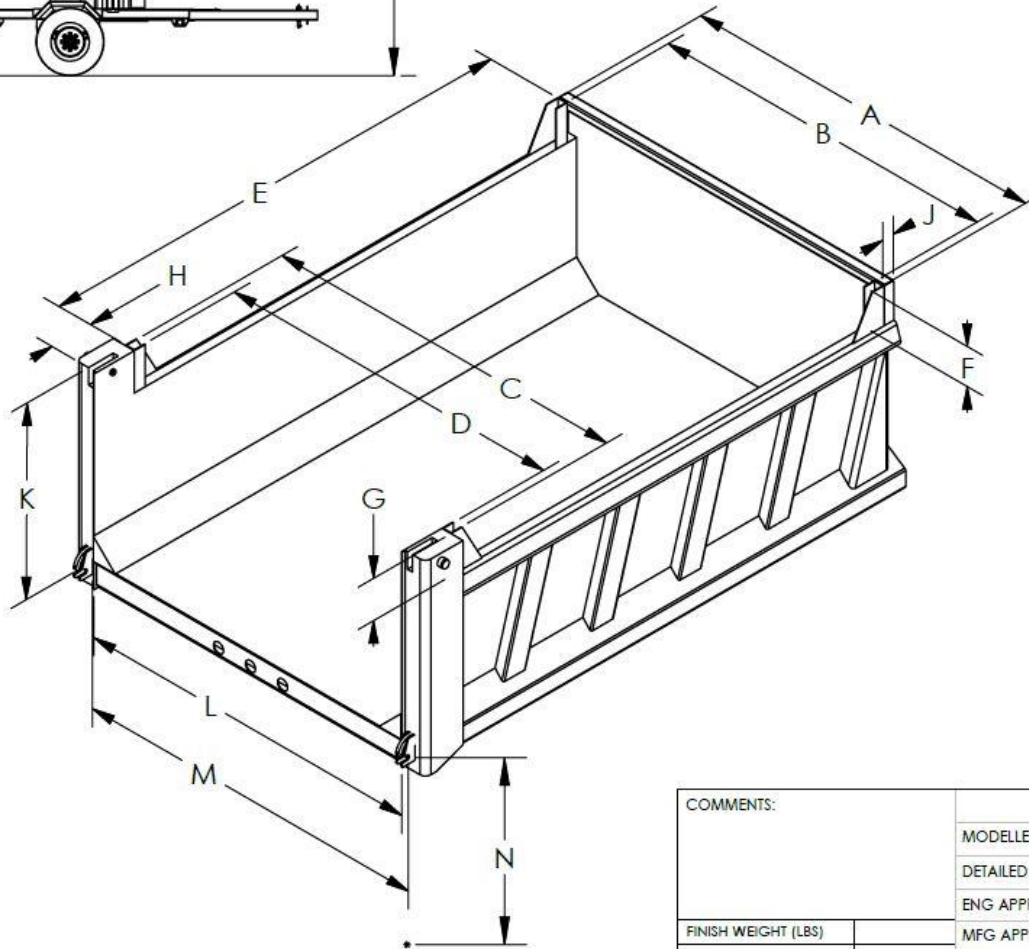


TABLE OF CONTENTS

DATA SHEET	1
PARTS BREAKDOWN	2
MOUNTING & OPERATING INSTRUCTION	4
WARRANTY	8



NOTE:
DIMENSION TO BOTTOM OF TUBE
AND TUBE DIAMETER IS ALSO
ACCEPTABLE.



DISTRIBUTER NAME	
END USER	
JOB OR QUOTE #	
PURCHASE ORDER #	

INFORMATION REQUIRED FOR QUOTING
AND BUILDING A TITAN LEAF CAP TO FIT A
SPECIFIC DUMP BODY. PLEASE MEASURE ACCURATELY
TO ASSURE PROPER FIT OF THE CAP TO THE BODY.

IF BODY DIFFERS FROM STANDARD BODY SHOWN
PLEASE INCLUDE PICTURES OF CORNER POSTS,
FRONT BULKHEAD, AND BOARD POCKET AREAS.

DIMENSION	DESCRIPTION
A	OUTSIDE POCKET WIDTH, FRONT
B	INSIDE POCKET WIDTH, FRONT
C	OUTSIDE POCKET WIDTH, REAR
D	INSIDE POCKET WIDTH, REAR
E	BOARD POCKET LENGTH
F	FRONT BOARD POCKET HEIGHT
G	REAR BOARD POCKET HEIGHT
H	TAILGATE FACE TO BOARD POCKET
J	FRONT OF BODY TO BOARD POCKET
K	CENTER OF LATCH TO TOP
L	INSIDE WIDTH
M	WIDTH BETWEEN LATCHES
N	LATCH CENTER TO GROUND
P	GROUND TO CENTER OF LEAF VAC DISCHARGE

COMMENTS:	NAME	DATE
	MODELLED	SHJ 2/14/18
	DETAILED	SHJ 2/14/18
	ENG APPR.	
FINISH WEIGHT (LBS)	MFG APPR.	
	DIMENSIONS ARE IN INCHES	
	TOLERANCES UNLESS OTHERWISE NOTED	
	FRACTIONAL	± 1/16
	BEND ANGLE	± .5°
	SQUARENESS	± .15°
	TWO PLACE DECIMAL	± .03
	THREE PLACE DECIMAL	± .005



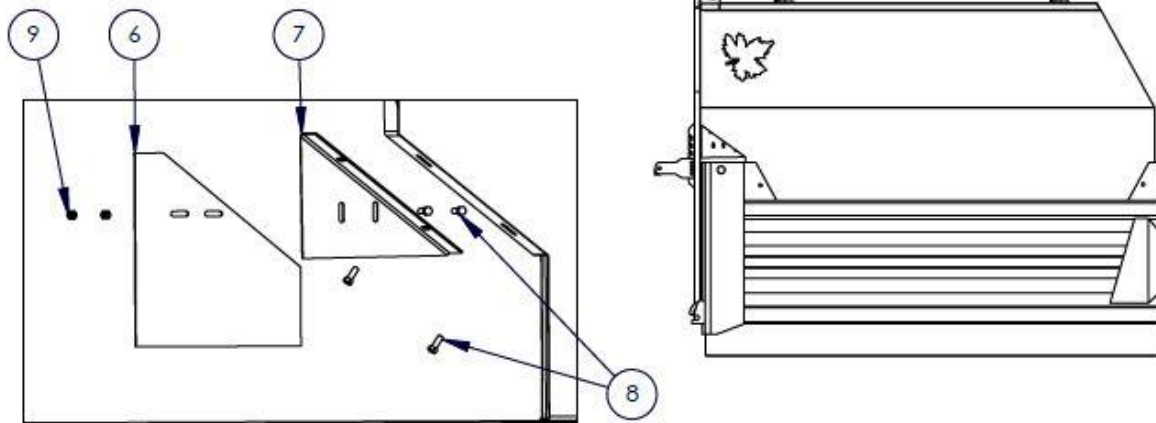
TITLE: DUMP BODY DATA SHEET, FOR TITAN
LEAF CAP

DWG. NO.
DUMP BODY DATA SHEET, LEAF CAP

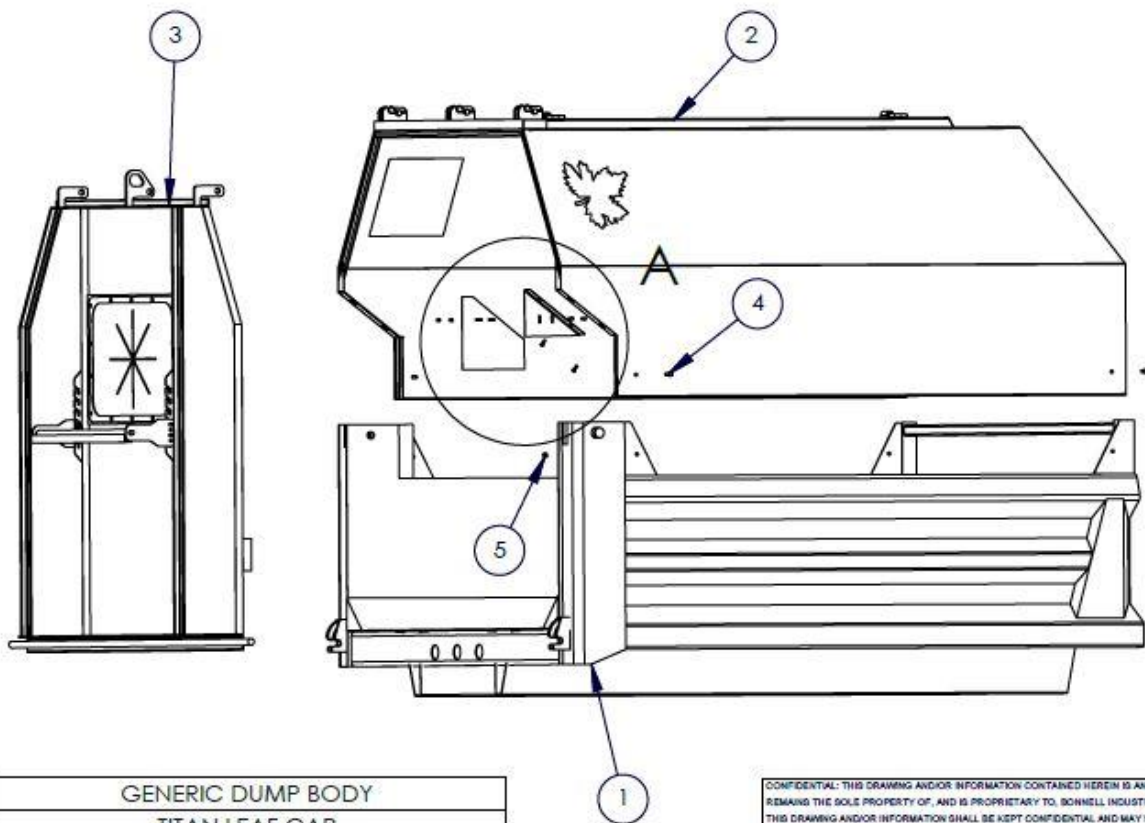
CONFIDENTIAL: THIS DRAWING AND/OR INFORMATION CONTAINED HEREIN IS AND REMAINS THE
SOLE PROPERTY OF, AND IS PROPRIETARY TO, BONNELL INDUSTRIES, INC. THIS DRAWING AND/OR
INFORMATION SHALL BE KEPT CONFIDENTIAL AND MAY NOT BE REPRODUCED, COPIED, MODIFIED,
DISCLOSED, TRANSFERRED, OR MADE AVAILABLE TO OTHERS, EXCEPT WITH THE EXPRESS WRITTEN
CONSENT OF BONNELL INDUSTRIES, INC. IT IS LOANED IN CONFIDENCE FOR MUTUAL ASSISTANCE
PURPOSES ONLY. BONNELL INDUSTRIES, INC. MAY AT ANY TIME, MODIFY THE DRAWING AND/OR
INFORMATION CONTAINED HEREIN.

FILE NAME:
DUMP BODY DATA SHEET, TITAN LEAF CAP

FILE NAME	TLC10 ON BODY
DWG NAME	TLC MANUAL



DETAIL A



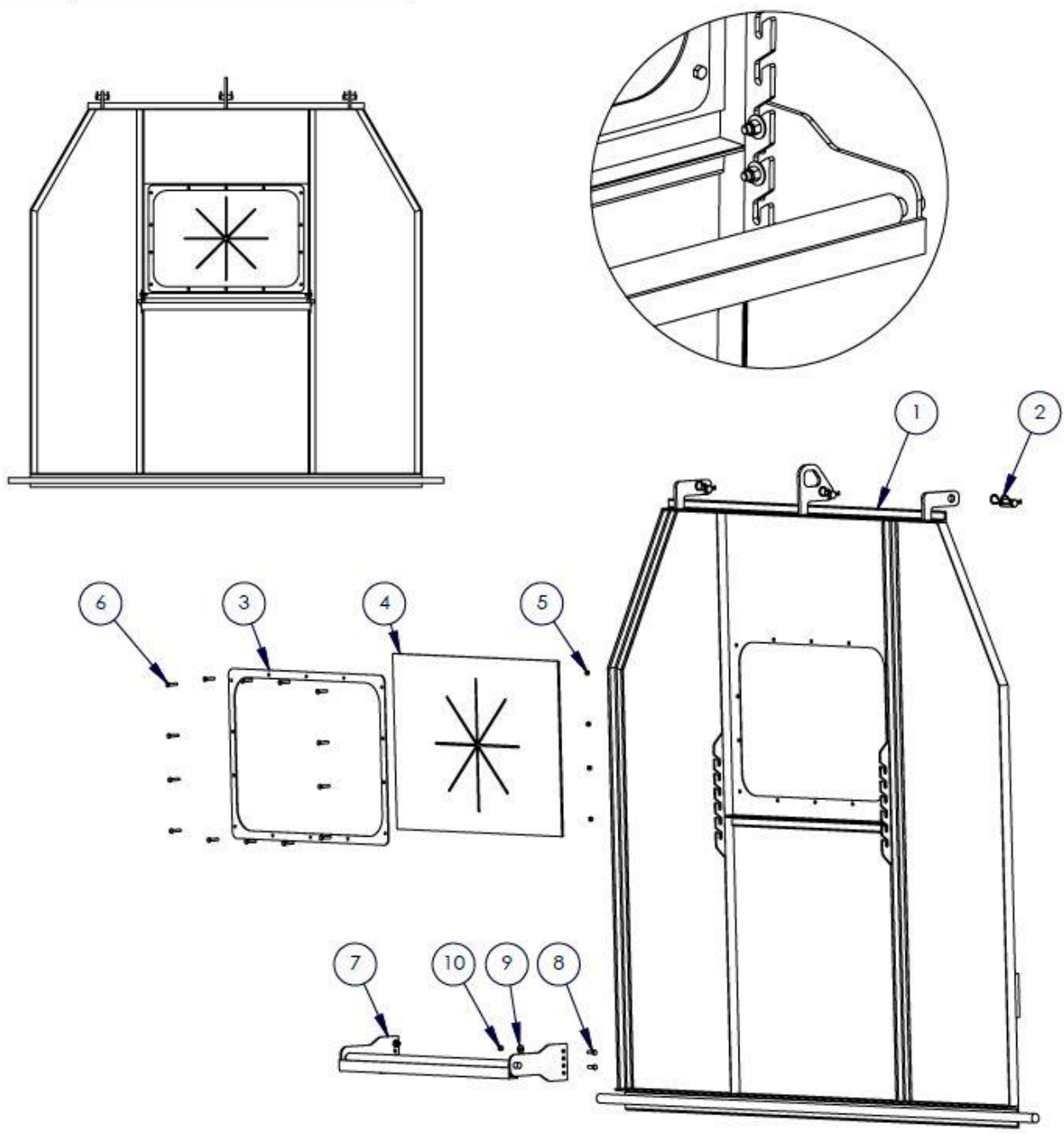
ITEM	QTY	DESCRIPTION
1	1	GENERIC DUMP BODY
2	1	TITAN LEAF CAP
3	1	TITAN LEAF CAP DOOR
4	4	1/2" BOLT LENGTH AS NEEDED
5	4	1/2" NUT
6	2	LEAF CAP CORNER SHIM
7	2	LEAF CAP CORNER COVER
8	4	3/8 X 1-1/2 HEX BOLT
9	4	3/8" NUT

CONFIDENTIAL: THIS DRAWING AND/OR INFORMATION CONTAINED HEREIN IS AND REMAINS THE SOLE PROPERTY OF, AND IS PROPRIETARY TO, BONNELL INDUSTRIES, INC. THIS DRAWING AND/OR INFORMATION SHALL BE KEPT CONFIDENTIAL AND MAY NOT BE REPRODUCED, COPIED, MODIFIED, DISCLOSED, TRANSFERRED, OR MADE AVAILABLE TO OTHERS, EXCEPT WITH THE EXPRESS WRITTEN CONSENT OF BONNELL INDUSTRIES, INC. IT IS LOANED IN CONFIDENCE FOR MUTUAL ASSISTANCE PURPOSES ONLY. BONNELL INDUSTRIES, INC. MAY AT ANY TIME, MODIFY THE DRAWING AND/OR INFORMATION CONTAINED HEREIN.



DIXON, ILLINOIS
PHONE: 800-851-9664

FILE NAME	TLC10 DOOR GENERIC
DWG NAME	MANUAL



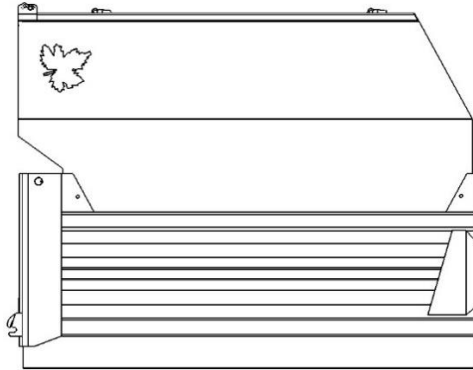
10	4	BON-000319	3/8"-16TPI HEX LOCK NUT NYLON INSERT
9	4	BON-000338	FLATWASHER,3/8" ZP
8	4	BON-000058	3/8"-16TPI X 1 1/4" LONG GR.8
7	1	BON-004118	LEAF BOX, STD ROLLER, 36" WIDE
6	14	BON-000032	5/16"-18TPI X 1 1/2" LONG GR.8
5	14	BON-000320	5/16"-18TPI HEX LOCK NUT NYLON INSERT
4	1	BON-000731	RUBBER INSERT
3	1	LV-1925	RETAINER PLATE, LEAF CAP/BOX
2	3	PMC-190400005	CLEVIS PIN, 1" X 2-1/8" WORKING LENGTH
1	1		LEAF CAP DOOR
ITEM	QTY	PART NUMBER	DESCRIPTION

CONFIDENTIAL: THIS DRAWING AND/OR INFORMATION CONTAINED HEREIN IS AND REMAINS THE SOLE PROPERTY OF, AND IS PROPRIETARY TO, BONNELL INDUSTRIES, INC. THIS DRAWING AND/OR INFORMATION SHALL BE KEPT CONFIDENTIAL AND MAY NOT BE REPRODUCED, COPIED, MODIFIED, DISCLOSED, TRANSFERRED, OR MADE AVAILABLE TO OTHERS, EXCEPT WITH THE EXPRESS WRITTEN CONSENT OF BONNELL INDUSTRIES, INC. IT IS LOANED IN CONFIDENCE FOR MUTUAL ASSISTANCE PURPOSES ONLY. BONNELL INDUSTRIES, INC. MAY AT ANY TIME, MODIFY THIS DRAWING AND/OR INFORMATION CONTAINED HEREIN.

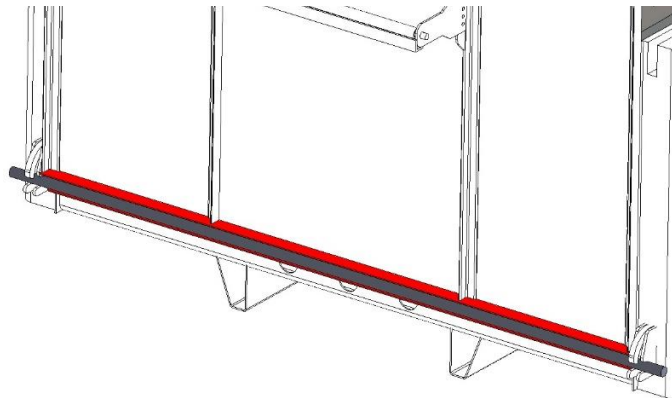
BONNELL INDUSTRIES INC
 TRUCK & ROAD EQUIPMENT
 DIXON, ILLINOIS
 PHONE: 800-851-9664

Leaf cap mounting instructions:

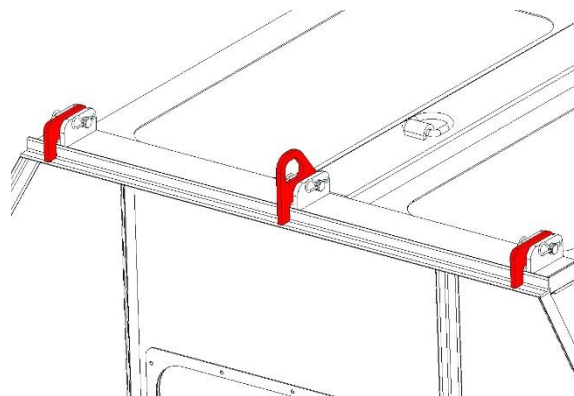
1. Establish a safe work zone with proper lifting capability. On the truck to be used, turn off power and engage parking brake.
2. Remove the tailgate from the truck, and side boards if equipped.
3. Install the Titan Leaf Cap into the truck board pockets using lifting eyes and a proper lifting device. Align the rear of Titan Leaf Cap with the truck bed tailgate frame. NOTE: Alignment critical to obtain a good seal on Titan Leaf Cap tailgate.



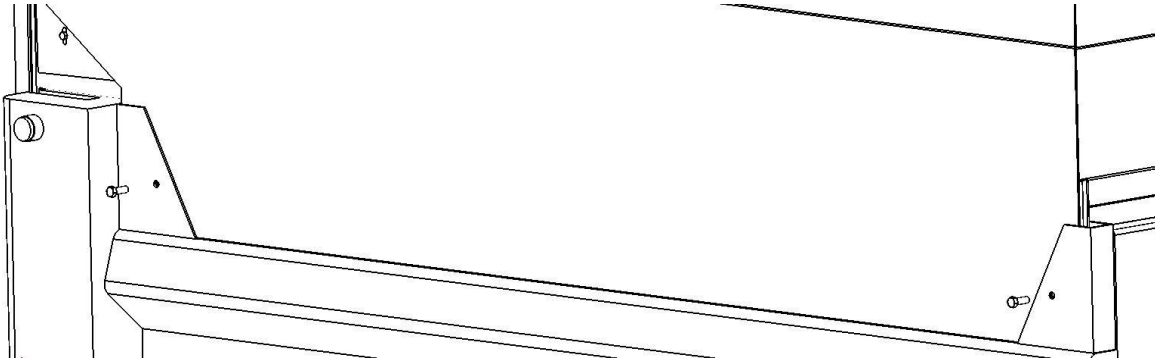
4. Position the Titan Leaf Cap door to the body. Verify that the door is centered side to side. NOTE: Door overlap with the Titan Leaf Cap may be different than the overlap on truck bed, depending upon the width of the board pocket spacing of the body.
5. Position the door at a height such that the lower angle is between the tailgate latches. Install the tail gate latch rod in the body latches to assist with keeping the lower edge of the door in place



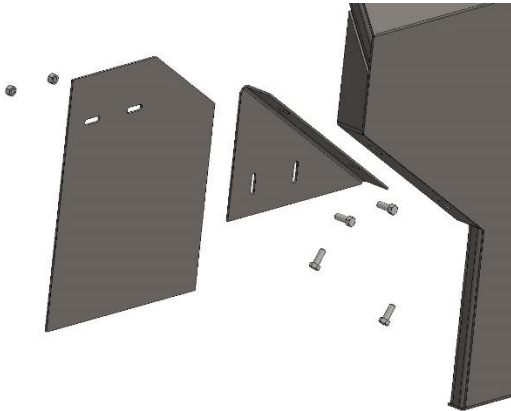
6. When door is positioned correctly, verify fit of the upper door hinges (supplied loose). Trim hinge legs if necessary, and weld hinges to the door. NOTE: Center hinge is equipped with a lifting eye for use when removing the door.



7. Weld tailgate latch rod to door. Note a shim plate may be necessary behind the rod to space it correctly to get a good door seal.
8. Verify final position of Titan Leaf Cap. Final adjustment may be needed forward or rearward to seal the tailgate properly. NOTE: a "perfect" tailgate seal may not be obtainable. Seal is dependent upon true vertical alignment and squareness of the rear of the dump body and the Titan Leaf Cap. Manufacturing tolerances of the Titan Leaf Cap, as well as different dump body manufacturers, will not always allow for a tight square fit on both sides.
9. After Titan Leaf Cap is positioned properly, drill a 9/16" hole in each board pocket corner plate, and install 1/2" bolts through the corner plates and the Leaf Cap side panels.



10. Install rear corner covers. Push corner covers out as far as possible, tight against body corner posts.



11. Install secondary shim plates. Trim as necessary to fit.
12. Back truck up to leaf vac. Position vac nozzle in location where it will penetrate through the leaf cap. Mark the rubber deflector, and cut to match the nozzle.
 - a. Option 1: Cut out a full circle for the nozzle to go into the box.
 - b. Option 2: Mark the circle of the chute, but cut it in pizza pie shapes, leaving the outer circle intact. This may provide a better seal of the nozzle.



13. Optional: For each season, use a can of Great Stuff or other foam sealant, and fill any gaps around the front panel or rear corners to reduce dust blowout during operation. This will have to be scraped off at the end of the season when the Titan Leaf Cap is removed.

Operation:

SPECIAL NOTE: this section of the manual is intended as a supplement to your specific municipal or business guidelines in leaf collection, and is not intended to be a *“complete leaf collection guide”*. Training is the key to safe and proper operation of this equipment. Ensure your operation is in compliance with all applicable codes and regulations.

Refer to your leaf vacuum manual for specific instructions pertaining to operation of that equipment.

Adjust engine RPM to match working conditions. Generally, lower RPM is better for dryer and dusty conditions. However, engines will have greater vibrate at certain rpms that vary by engine. For example, the vibration of the engine may be higher at 2000 rpm than it is at 2200 rpm.

It may be necessary to equip the Titan Leaf Cap with a tarp to assist in dust control.

Fill the Titan Leaf Cap as much as practical, while staying within the GVW of the tow chassis, and all Federal, State, and Local weight restrictions. Note that wet conditions will greatly increase the payload weight of a full load of leaves.

Dump the Titan Leaf Cap as you would a normal dump body, utilizing the truck tailgate release. As the load dumps, pull forward to clear the load. The tailgate will slide over the pile as you drive forward.

Note: Never back up with the body raised, as damage to the tailgate could occur.

It is possible to utilize the Titan Leaf Caps as a chipper hood. To do this, simply remove the tailgate, and the corner post cover plates. The standard body tailgate can then be used, either tipping normal, or it can be hinged at the bottom to keep out of the way.

Storage and Maintenance:

Remove the Titan Leaf Cap tailgate utilizing the lifting eye on the center ear. Place it in a safe, flat place where it won't fall, or get damaged during the off season.

Remove the 1/2" mounting bolts and lift off the Titan Leaf Cap using the lifting eyes on the roof. Place it in a safe, flat place where it can be stored and inspected.

Inspect and replace or repair the tarp, nozzle flap, screens, and fasteners as necessary.



WARRANTY

Issued: January 1, 2010

Bonnell Industries, Inc. warrants to the original purchaser that if any part of the product proves to be defective in workmanship or material within one year of the date of original installation and is returned to us freight prepaid within 30 days after such defect is discovered and notification thereof is provided Bonnell, we will either replace or repair the defective part (our option). This warranty does not apply to damage resulting from neglect, misuse, accident or improper installation or maintenance. Charges for field service, labor, or other expenses not previously authorized and approved in writing by Bonnell Industries, Inc. will not be accepted. This warranty is exclusive and in lieu of all other warranties whether expressed or implied. Bonnell Industries, Inc. neither assumes nor authorizes anyone to assume for it any other obligation or liability in connection with this warranty, and will not be liable for consequential damages. This warranty applies only to products made and/or supplied by Bonnell Industries, Inc. and does not apply to other products not made or supplied by us and to which our products may be attached, such as trucks. We accept no responsibility for damages to such other products, even if our product is alleged to have contributed to the damage of the other product.

Engines, drive line components, hydraulic, electrical, or other components furnished by other manufacturers and used with our products are warranted by that manufacturer and not by Bonnell Industries, Inc. the manufacturer's own warranty will apply to these parts. Hydraulic or electrical components are not to be disassembled without the express written permission of Bonnell Industries, Inc.

All defective parts returned from an end user must include the unit model, serial number, date installed, and dealer from whom purchased.

Bonnell Industries, Inc. reserves the right to make changes or improvements to its products without incurring any liability or obligation and without being required to make corresponding changes or improvements to products manufactured or sold prior to those changes or improvements.

The Bonnell Industries, Inc. Warranty Policy is subject to change without notice.

Product Information

When ordering parts, please refer to the information below.

INSTALLATION DATE:

This product was manufactured by Bonnell Industries, Inc.,
located at 1385 Franklin Grove Rd.,
in the city of Dixon, Illinois, U.S.A.

MADE IN THE USA 

Titan CHIPPER CAP™

INSTALLATION AND OPERATION MANUAL

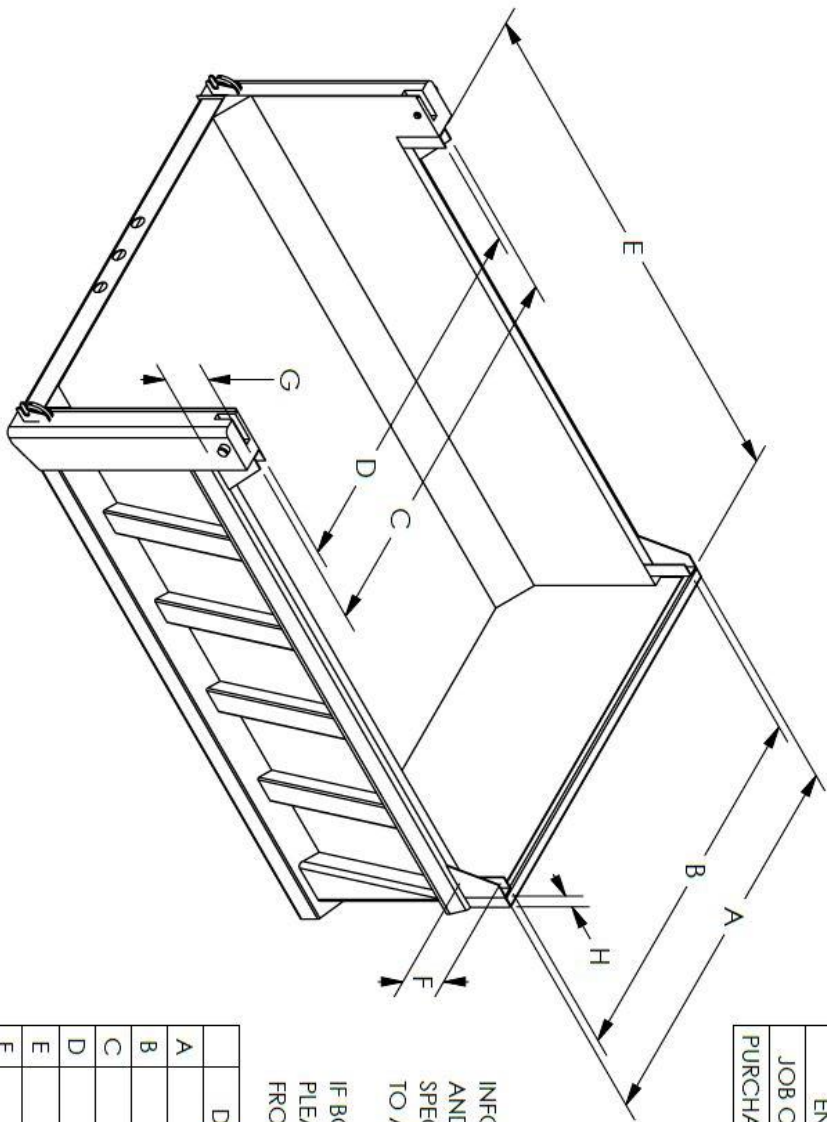
REV 090920



TABLE OF CONTENTS

DATA SHEET.....	1
PARTS BREAKDOWN.....	2
MOUNTING INSTRUCTIONS.....	3
WARRANTY.....	4

DISTRIBUTER NAME	
END USER	
JOB OR QUOTE #	
PURCHASE ORDER #	



INFORMATION REQUIRED FOR QUOTING AND BUILDING A CHIPPER CAP TO FIT A SPECIFIC DUMP BODY. PLEASE MEASURE ACCURATELY TO ASSURE PROPER FIT OF THE CAP TO THE BODY.

IF BODY DIFFERS FROM STANDARD BODY SHOWN PLEASE INCLUDE PICTURES OF CORNER POSTS, FRONT BULKHEAD, AND BOARD POCKET AREAS.

DIMENSION	DESCRIPTION
A	OUTSIDE POCKET WIDTH, FRONT
B	INSIDE POCKET WIDTH, FRONT
C	OUTSIDE POCKET WIDTH, REAR
D	INSIDE POCKET WIDTH, REAR
E	BOARD POCKET LENGTH
F	FRONT BOARD POCKET HEIGHT
G	REAR BOARD POCKET HEIGHT
H	FRONT OF BODY TO BOARD POCKET

COMMENTS:	
MODELLED	SHJ 2/14/18
DETAILED	SHJ 2/14/18
ENG APPR.	
MFG APPR.	
FINISH WEIGHT (LBS)	

TITLE: DUMP BODY DATA SHEET, FOR CHIPPER CAP

TRUCK & ROAD EQUIPMENT

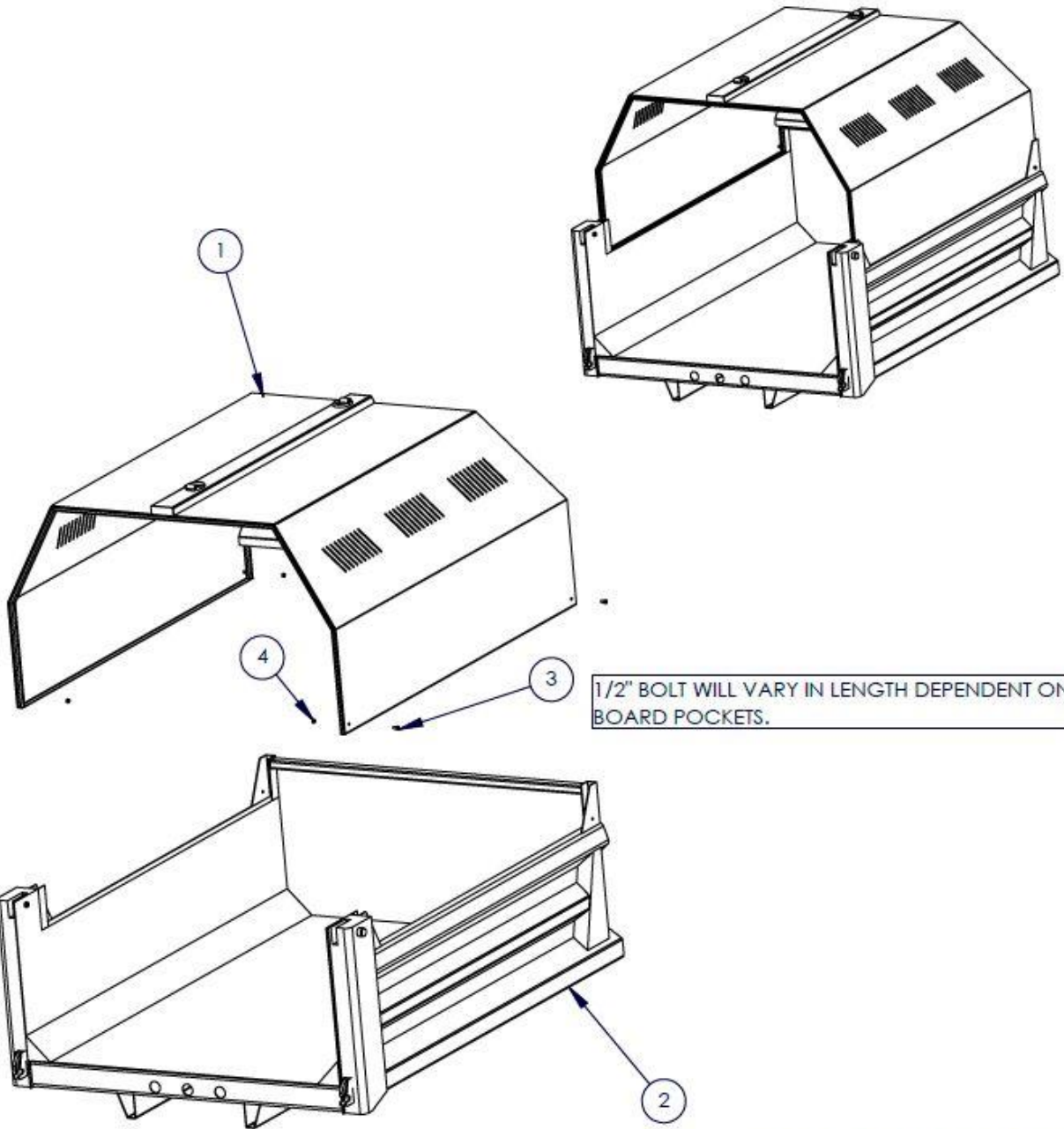
DIMENSIONS ARE IN INCHES	
TOLERANCES UNLESS OTHERWISE NOTED	
FRAC TIONAL	1/16
BEND ANGLE	1.5°
SQUARENESS	±.15*
TWO PLACE DECIMAL	±.03
THREE PLACE DECIMAL	±.005

DWG. NO.	
DUMP BODY DATA SHEET, CHIPPER	

CONFIDENTIAL: THIS DRAWING AND/OR INFORMATION CONTAINED HEREIN IS AND REMAINS THE SOLE PROPERTY OF, AND IS PROPRIETARY TO, BONNELL INDUSTRIES, INC. THIS DRAWING IS NOT TO BE REPRODUCED, COPIED, REPRODUCED, TRANSMITTED, OR IN ANY MANNER MADE AVAILABLE TO OTHERS WITHOUT THE EXPRESS WRITTEN CONSENT OF BONNELL INDUSTRIES, INC. IT IS LOANED IN CONFIDENCE FOR A LIMITED PURPOSE AND IS NOT TO BE REPRODUCED, COPIED, REPRODUCED, TRANSMITTED, OR IN ANY MANNER MADE AVAILABLE TO OTHERS WITHOUT THE EXPRESS WRITTEN CONSENT OF BONNELL INDUSTRIES, INC. ANY ATTEMPT TO REPRODUCE, COPY, OR IN ANY MANNER MAKE AVAILABLE TO OTHERS WITHOUT THE EXPRESS WRITTEN CONSENT OF BONNELL INDUSTRIES, INC. WILL BE CONSIDERED A VIOLATION OF CONFIDENTIALITY AND WILL BE PROSECUTED TO THE FULL EXTENT OF THE LAW.

FILE NAME:
DUMP BODY DATA SHEET, CHIPPER CAP

FILE NAME	CHIPPER CAP ASSEMBLY
DWG NAME	Sheet1



1/2" BOLT WILL VARY IN LENGTH DEPENDENT ON BOARD POCKETS.

ITEM	QTY	DESCRIPTION
4	4	1/2 LOCKNUT
3	4	1/2 HEX BOLT
2	1	DUMP BODY
1	1	CUSTOM CHIPPER CAP

CONFIDENTIAL: THIS DRAWING AND/OR INFORMATION CONTAINED HEREIN IS AND REMAINS THE SOLE PROPERTY OF, AND IS PROPRIETARY TO, BONNELL INDUSTRIES, INC. THIS DRAWING AND/OR INFORMATION SHALL BE KEPT CONFIDENTIAL AND MAY NOT BE REPRODUCED, COPIED, MODIFIED, DISCLOSED, TRANSFERRED, OR MADE AVAILABLE TO OTHERS, EXCEPT WITH THE EXPRESS WRITTEN CONSENT OF BONNELL INDUSTRIES, INC. IT IS LOANED IN CONFIDENCE FOR MUTUAL ASSISTANCE PURPOSES ONLY. BONNELL INDUSTRIES, INC. MAY AT ANY TIME, MODIFY THE DRAWING AND/OR INFORMATION CONTAINED HEREIN.



BONNELL INDUSTRIES INC
TRUCK & ROAD EQUIPMENT
DIXON, ILLINOIS
PHONE: 800-851-9664

Titan Chipper Cap mounting instructions:

1. Establish a safe work zone with proper lifting capability. On the truck to be used, turn off power and engage parking brake.
2. Remove the tailgate from the truck, and side boards if equipped.
3. Install the Titan Chipper Cap into the truck board pockets using lifting eyes and a proper lifting device.
4. After Titan Chipper Cap is positioned properly, drill a 9/16" hole in each board pocket corner plate, and install 1/2" bolts through the corner plates and the Chipper Cap side panels.

Operation:

SPECIAL NOTE: this section of the manual is intended as a supplement to your specific municipal or business guidelines in debris collection, and is not intended to be a *"complete wood chipper guide"*. Training is the key to safe and proper operation of this equipment. Ensure your operation is in compliance with all applicable codes and regulations.

Refer to your wood chipper manual for specific instructions pertaining to operation of that equipment.

Fill the Titan Chipper Cap as much as practical, while staying within the GVW of the tow chassis, and all Federal, State, and Local weight restrictions. Note that wet conditions may increase the payload weight of a full load of chips.

Dump the Titan Chipper Cap as you would a normal dump body, utilizing the truck tailgate release. As the load dumps, pull forward to clear the load. The standard body tailgate can be used, either tipping normal, or it can be hinged at the bottom to keep out of the way.

Storage and Maintenance:

Remove the 1/2" mounting bolts and lift off the Titan Chipper Cap using the lifting eyes on the roof. Place it in a safe, flat place where it can be stored and inspected.

Inspect and repair as necessary.



WARRANTY

Issued: January 1, 2010

Bonnell Industries, Inc. warrants to the original purchaser that if any part of the product proves to be defective in workmanship or material within one year of the date of original installation and is returned to us freight prepaid within 30 days after such defect is discovered and notification thereof is provided Bonnell, we will either replace or repair the defective part (our option). This warranty does not apply to damage resulting from neglect, misuse, accident or improper installation or maintenance. Charges for field service, labor, or other expenses not previously authorized and approved in writing by Bonnell Industries, Inc. will not be accepted. This warranty is exclusive and in lieu of all other warranties whether expressed or implied. Bonnell Industries, Inc. neither assumes nor authorizes anyone to assume for it any other obligation or liability in connection with this warranty, and will not be liable for consequential damages. This warranty applies only to products made and/or supplied by Bonnell Industries, Inc. and does not apply to other products not made or supplied by us and to which our products may be attached, such as trucks. We accept no responsibility for damages to such other products, even if our product is alleged to have contributed to the damage of the other product.

Engines, drive line components, hydraulic, electrical, or other components furnished by other manufacturers and used with our products are warranted by that manufacturer and not by Bonnell Industries, Inc. the manufacturer's own warranty will apply to these parts. Hydraulic or electrical components are not to be disassembled without the express written permission of Bonnell Industries, Inc.

All defective parts returned from an end user must include the unit model, serial number, date installed, and dealer from whom purchased.

Bonnell Industries, Inc. reserves the right to make changes or improvements to its products without incurring any liability or obligation and without being required to make corresponding changes or improvements to products manufactured or sold prior to those changes or improvements.

The Bonnell Industries, Inc. Warranty Policy is subject to change without notice.

Product Information

When ordering parts, please refer to the information below.

INSTALLATION DATE:

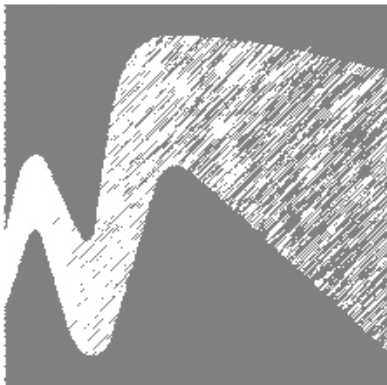
This product was manufactured by Bonnell Industries, Inc.,
located at 1385 Franklin Grove Rd.,
in the city of Dixon, Illinois, U.S.A.

MADE IN THE USA 

TM

BONNELL INDUSTRIES INC

TRUCK & ROAD EQUIPMENT



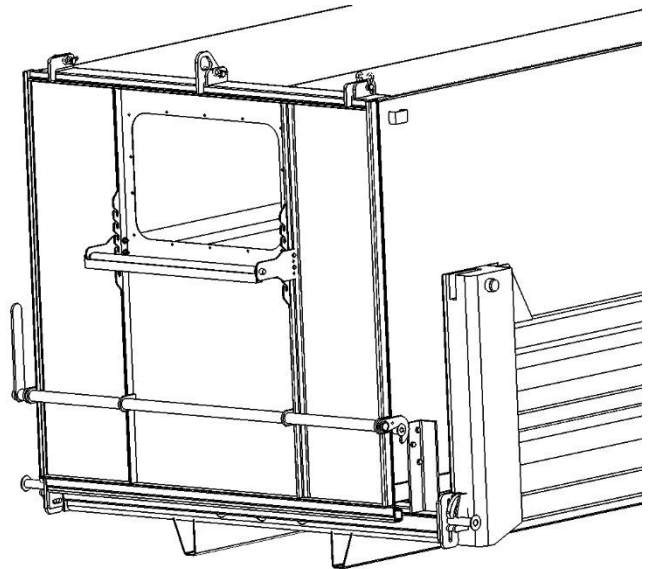
MOUNTING INSTRUCTIONS

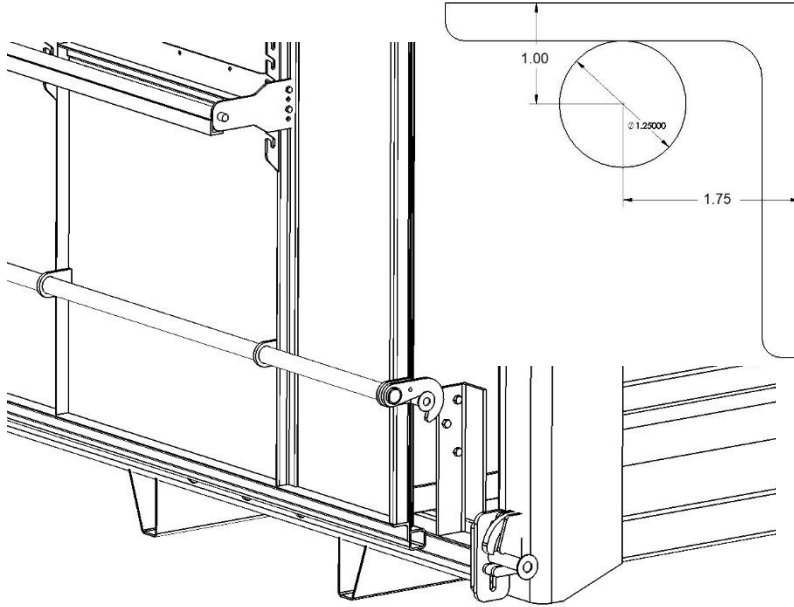
FOR



LEAF BOX TAILGATE LATCH KIT

REV. 12/18/19





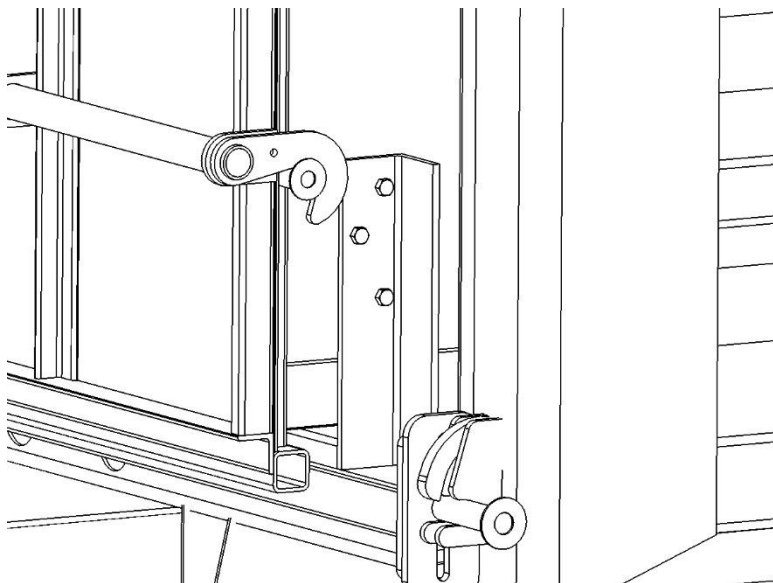
**STEP 1
POSITION LEAF BOX:**

Install leaf box in body as far forward as possible, and centered side to side. Allow clearance for spinner chute, and other accessories on spreader.

Locate cross angle so that the center of the angle would be aligned with the latch pin. (SEE PIC. FOR REFERENCE)

Position 15" upright angles as shown, and trim as required.

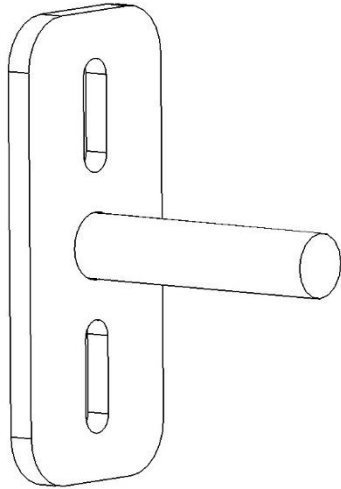
Locate (3) 9/16" mounting holes in angles to bolt to leaf box. When locating holes, double check clearance for leaf box chain, floor, and other obstacles.



**STEP 2.
MOUNT ANGLE:**

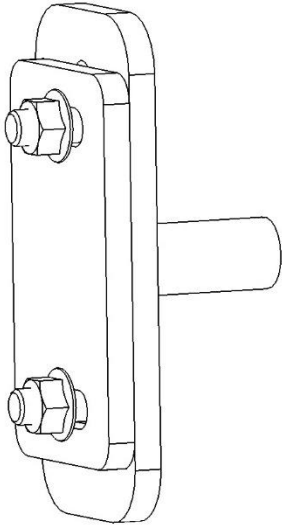
Install (3) 1/2x1-1/4 hex bolts and flange nuts as shown. Flange nuts go on inside of leaf box.

After bolting, weld upright angles solid to main cross angle.



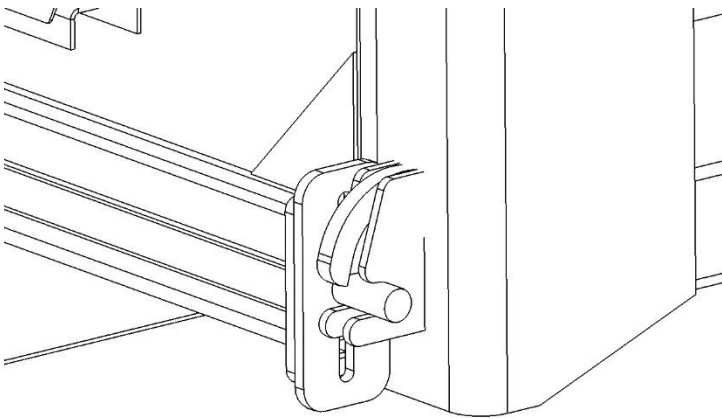
**STEP 3
WELD PIN:**

Weld 1-1/4" pin to plate BV2-003099.



**STEP 4
BOLT PLATES TOGETHER:**

Loosely bolt plates BV2-003098 and BV2-003099 together using two 5/8x2 bolts, washers, and nuts.

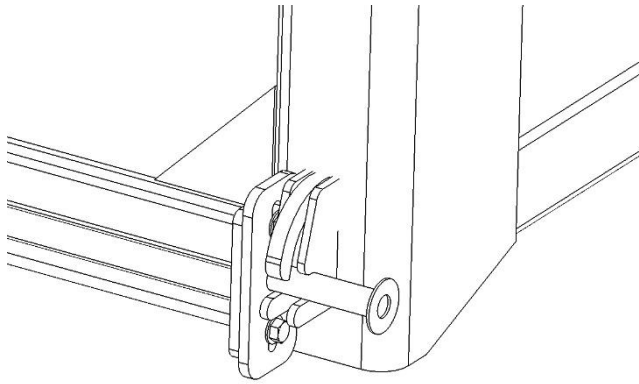


**STEP 5
POSITION PLATES:**

Put plates in latch and position on cross angle (Allow room for adjustment). Once in position tack weld the plates to cross angle.

**STEP 6
WELD:**

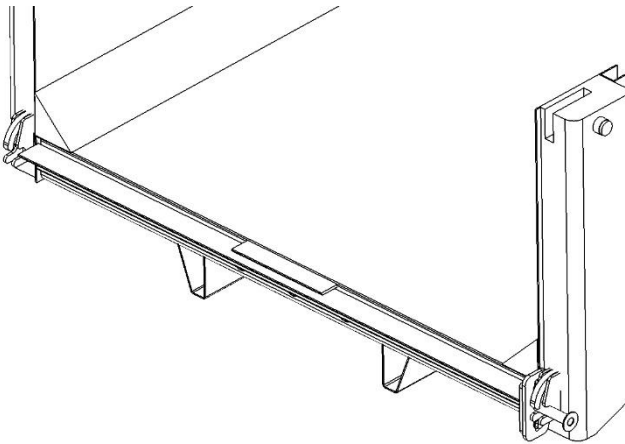
Fully weld adjustment plate and upright angles to cross angle. (see parts breakdown)



STEP 7
TRIM PIN:

Cut down pin size if there is excess that will not be needed. Allow for approx. $\frac{1}{2}$ " from latch to washer.

Then weld washer on to the end of pin

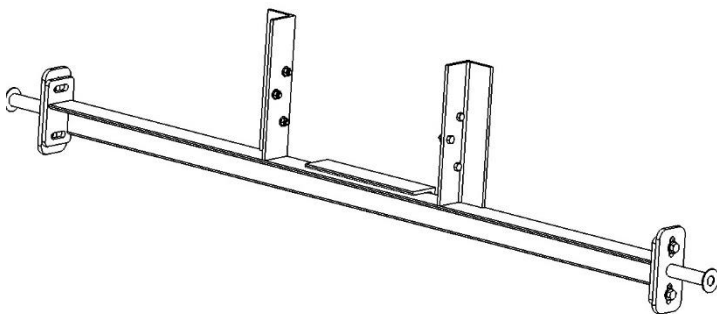


STEP 8
POSITION BUMP STOP:

Install 15" angle in center of main mounting angle. Front face of bump stop angle should be between $\frac{1}{16}$ " and $\frac{1}{8}$ " from face of dump body. The bump stop will help keep the leaf box in place during sudden stops.

Bump stop may not be needed if angle is close to body already.

WELD BUMP STOP ON ALL TOP EDGES (3 SIDES)

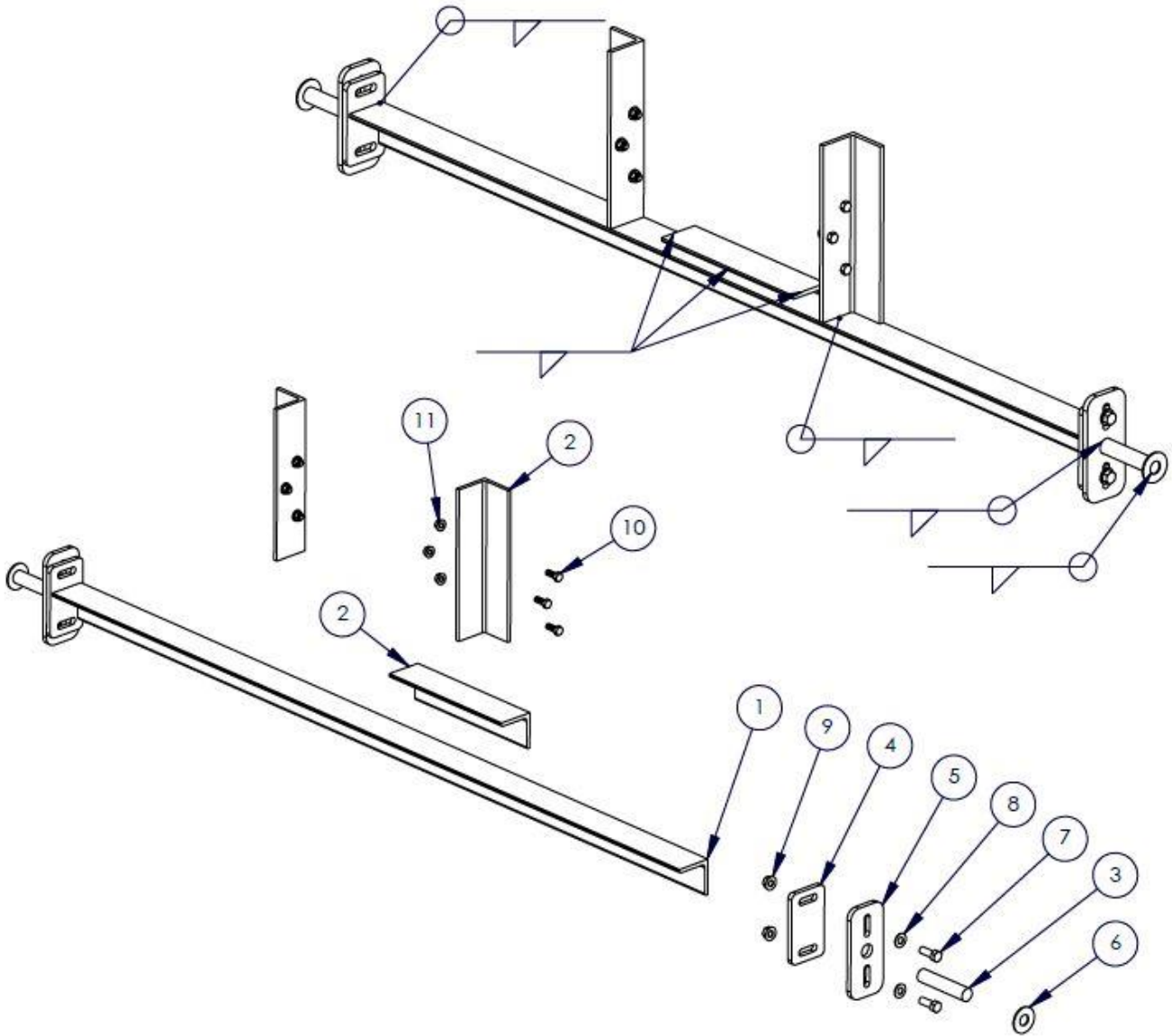


STEP 9
PAINT:

Unbolt and remove assembly for painting.

This completes installation.

FILE NAME	BV-1325-manual
DWG NAME	Sheet1



ITEM	QTY	PART NUMBER	DESCRIPTION
11	6	BV2-001649	1/2" SERR. FLANGED NUT
10	6	BON-000106	1/2 X 1-1/4 HEX BOLT
9	4	BON-000307F	5/8" FLANGED LOCK NUT
8	4	BON-000341	5/8" FLAT WASHER
7	4	BON-000152	5/8 X 1-3/4 HEX BOLT
6	2	BON-000345	1" FLAT WASHER
5	2	BV2-3099	VERTICAL ADJUSTMENT PLATE
4	2	BV2-3098	HORIZONTAL ADJUSTMENT PLATE
3	2	BON-003832	1-1/4 CRR X 6"
2	3	BV-1325-1	L3-1/2X3.5X3/8 X 15"
1	1	BV-1325-2	L3-1/2X3.5X3/8 X 84"

CONFIDENTIAL: THIS DRAWING AND/OR INFORMATION CONTAINED HEREIN IS AND REMAINS THE SOLE PROPERTY OF, AND IS PROPRIETARY TO, BONNELL INDUSTRIES, INC. THIS DRAWING AND/OR INFORMATION SHALL BE KEPT CONFIDENTIAL AND MAY NOT BE REPRODUCED, COPIED, MODIFIED, DISCLOSED, TRANSFERRED, OR MADE AVAILABLE TO OTHERS, EXCEPT WITH THE EXPRESS WRITTEN CONSENT OF BONNELL INDUSTRIES, INC. IT IS LOANED IN CONFIDENCE FOR MUTUAL ASSISTANCE PURPOSES ONLY. BONNELL INDUSTRIES, INC. MAY AT ANY TIME, MODIFY THE DRAWING AND/OR INFORMATION CONTAINED HEREIN.

BONNELL INDUSTRIES INC.
TRUCK & ROAD EQUIPMENT
DIXON, ILLINOIS
PHONE: 800-851-9664



WARRANTY

Issued: January 1, 2010

Bonnell Industries, Inc. warrants to the original purchaser that if any part of the product proves to be defective in workmanship or material within one year of the date of original installation and is returned to us freight prepaid within 30 days after such defect is discovered and notification thereof is provided Bonnell, we will either replace or repair the defective part (our option). This warranty does not apply to damage resulting from neglect, misuse, accident or improper installation or maintenance. Charges for field service, labor, or other expenses not previously authorized and approved in writing by Bonnell Industries, Inc. will not be accepted. This warranty is exclusive and in lieu of all other warranties whether expressed or implied. Bonnell Industries, Inc. neither assumes nor authorizes anyone to assume for it any other obligation or liability in connection with this warranty, and will not be liable for consequential damages. This warranty applies only to products made and/or supplied by Bonnell Industries, Inc. and does not apply to other products not made or supplied by us and to which our products may be attached, such as trucks. We accept no responsibility for damages to such other products, even if our product is alleged to have contributed to the damage of the other product.

Engines, drive line components, hydraulic, electrical, or other components furnished by other manufacturers and used with our products are warranted by that manufacturer and not by Bonnell Industries, Inc. the manufacturer's own warranty will apply to these parts. Hydraulic or electrical components are not to be disassembled without the express written permission of Bonnell Industries, Inc.

All defective parts returned from an end user must include the unit model, serial number, date installed, and dealer from whom purchased.

Bonnell Industries, Inc. reserves the right to make changes or improvements to its products without incurring any liability or obligation and without being required to make corresponding changes or improvements to products manufactured or sold prior to those changes or improvements.

The Bonnell Industries, Inc. Warranty Policy is subject to change without notice.

Product Information

When ordering parts, please refer to the information below.

INSTALLATION DATE:

This product was manufactured by Bonnell Industries, Inc.,
located at 1385 Franklin Grove Rd.,
in the city of Dixon, Illinois, U.S.A.

MADE IN THE USA 



INSTALLATION & OPERATION MANUAL

REV: 08/24/20

Manual Part No. LV-1966

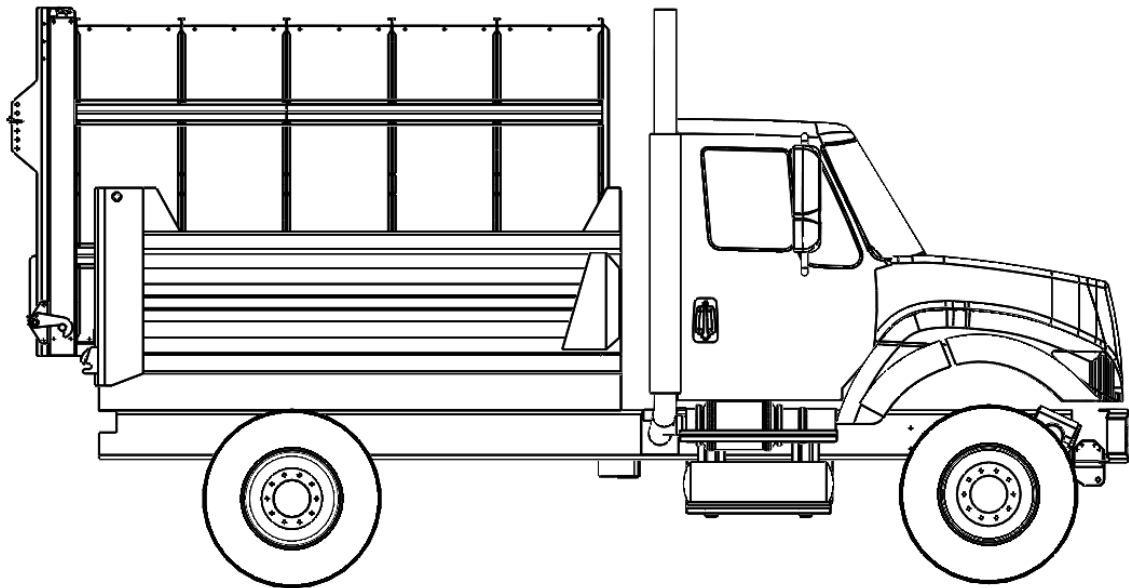


TABLE of CONTENTS

Specifications	2
Safety	3
Installation	7
Operation	9
Service parts	11
Warranty	Back cover

SPECIFICATIONS

Overall length	137.3"	Top, side & rear panel ...	16 gauge galvanized
Overall width	81.3"	Front panel	14 gauge galvanized
Overall height	76.8"	Lower skirting	10 gauge galvanized
Capacity	14.6 yd ³	Door framing ...	7 gauge & 1/4" powder coat
Empty weight	1,280 lbs	Extension kit length	24"
Gross weight * ...	7,120 lbs	Extension capacity	2.9 yd ³

* - Leaf density calculated at 400 lbs per cubic yard.

Bonnell Industries Inc. reserves the right under its product improvement policy to change construction or design details and furnish equipment when so altered without reference to illustrations or specifications used herein.

© 2006 Bonnell Industries, Inc.

SAFETY

Read this manual before attempting to install or operate this equipment.



This symbol means **ALERT**. Any time you see this symbol, you are warned that your safety is in danger. Be careful!

SAFETY GUIDELINES TO FOLLOW

- Turn off truck engine when servicing or installing equipment.
- Follow all recommended operating procedures.
- Follow a regular maintenance schedule so that the equipment is kept in good operating condition. Improper maintenance can lead to equipment failure during operation, making for unsafe conditions.
- Recognize and avoid hazardous situations during the installation, operation and service of this equipment.
- Pay attention to, and respect all safety decals. They are there to protect you from injury. Replacement safety decals are available from Bonnell Industries.

AVOID ACCIDENTS

Most accidents, wherever they occur, are caused by the failure of an individual to follow simple and fundamental safety rules or regulations. Most accidents can be prevented by recognizing the real cause of accidents and what precautions should be taken to avoid unsafe situations.

Regardless of the care used in the design and construction of this equipment, there are many situations that cannot be completely safeguarded against without interference to reasonable accessibility and efficient operation of the equipment.

A careful, knowledgeable operator is the best insurance against accidents. The complete observance of a simple safety rule can prevent injury:



Never attempt to clean, lubricate, or adjust a machine while it is in motion.

NATIONAL SAFETY COUNCIL

ALWAYS THINK SAFETY FIRST

The purpose of this manual is to inform you, the operator, with the necessary information to properly install, operate, and service this equipment. These instructions cannot replace the fundamental knowledge that a person must possess in order to safely operate this equipment. The person must be qualified and possess the mechanical skills to install and operate this equipment. Since the life of the equipment depends largely upon the care it is given, Bonnell Industries suggests that this manual be read and understood by those individuals that will be working with this equipment. If for any reason you do not understand these instructions, contact your authorized service center or Bonnell Industries at 815-284-3819. Through experience and following these instructions, an operator will develop a sufficient understanding of the care and safe operation of this equipment.

The need for safety cannot be stressed enough. Bonnell Industries urges you to make safety your top priority when operating this equipment.

Accidents can be avoided!

SAFETY PRECAUTIONS



The best safety device is a careful and knowledgeable operator.

This symbol means be **ALERT!** Your safety is involved! Read and understand all safety information before operating equipment.

Improper use of this equipment can result in serious injury or death. To reduce this risk, give complete and undivided attention to the job at hand. Always follow these safety precautions.

PREPARATION

- Know your controls.
- Read all instruction manuals pertaining to this equipment.
- Learn how to stop the equipment quickly in an emergency.
- Do not allow children or untrained adults to operate this equipment.
- Keep all bystanders a safe distance from this equipment while in operation.

SAFETY DURING OPERATION

- Observe settings on all equipment controls.
- Make sure all equipment is turned off before starting engine.
- Always check area around equipment for hidden hazards prior to engaging or operating controls.
- To avoid machine entanglement, always wear relatively tight and belted clothing when operating equipment.
- Stop, shut down and inspect equipment if unusual movement or sounds are observed. Repair damage before placing equipment back into service.
- Never operate equipment without all guards and shields properly installed.
- Disengage power and turn off equipment:
 - Before leaving operator position.
 - Before making any repairs or adjustments.
 - Before performing any service work.
 - When not in use.
- Take all possible precautions when leaving the equipment unattended:
 - Disengage hydraulic systems
 - Shut off engine
 - Set parking brake
 - Remove key

LIGHT BAR INSTALLATION (if furnished)

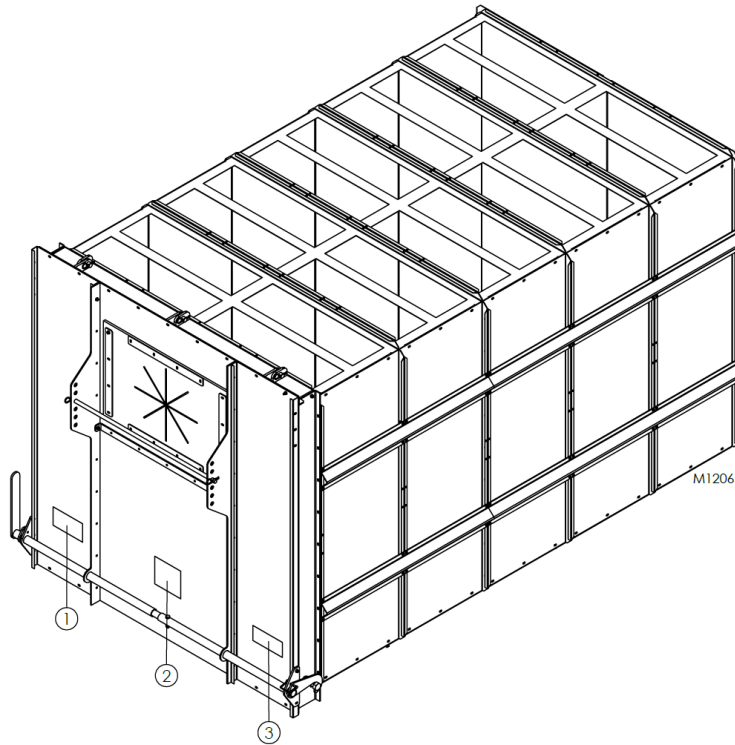
- Depending on the distance installed above ground, an auxiliary light bar may not meet federal lighting regulations. The lighting equipment installer is responsible for complying with all federal lighting regulations.
- Any additional wiring connections made to the truck chassis for “optional” lighting must be made in accordance with the vehicle manufacturer’s recommendations.

SAFETY DECALS

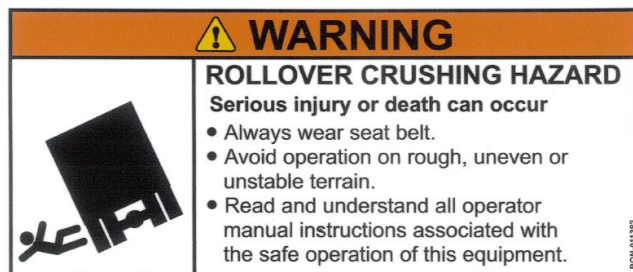
- It is the responsibility of the equipment owner to replace any safety decals that become unreadable through physical damage or deterioration.
- Replacement decals should be positioned in the same location as the damaged decals removed.
- Read and observe all **DANGER**, **WARNING** and **CAUTION** safety decals appearing on the equipment.
- If safety decals become damaged, call Bonnell Industries at 800-851-9664 for replacement labels.

SAFETY DECALS

Replace immediately if damaged or unreadable



1. BON-011375



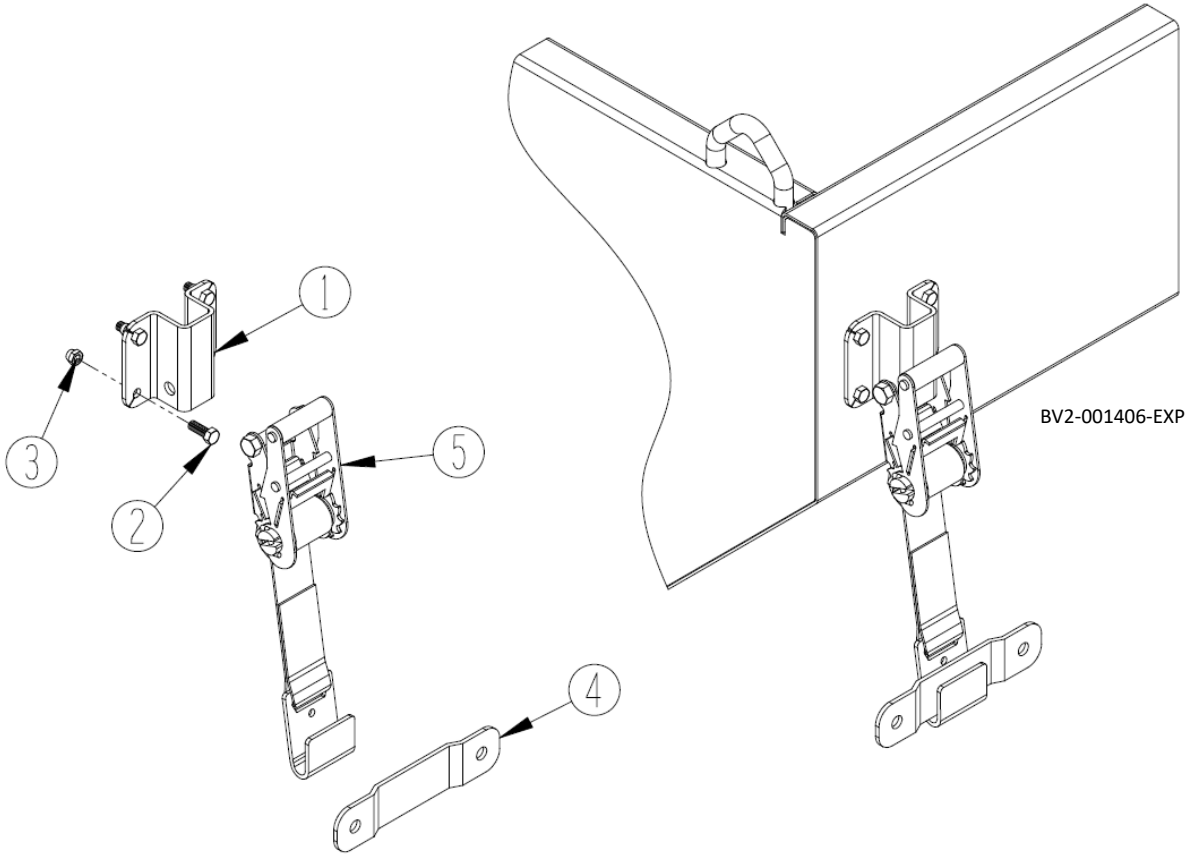
3. BON-011377



2. BON-011382

INSTALLATION

LEAF BODY TO CHASSIS

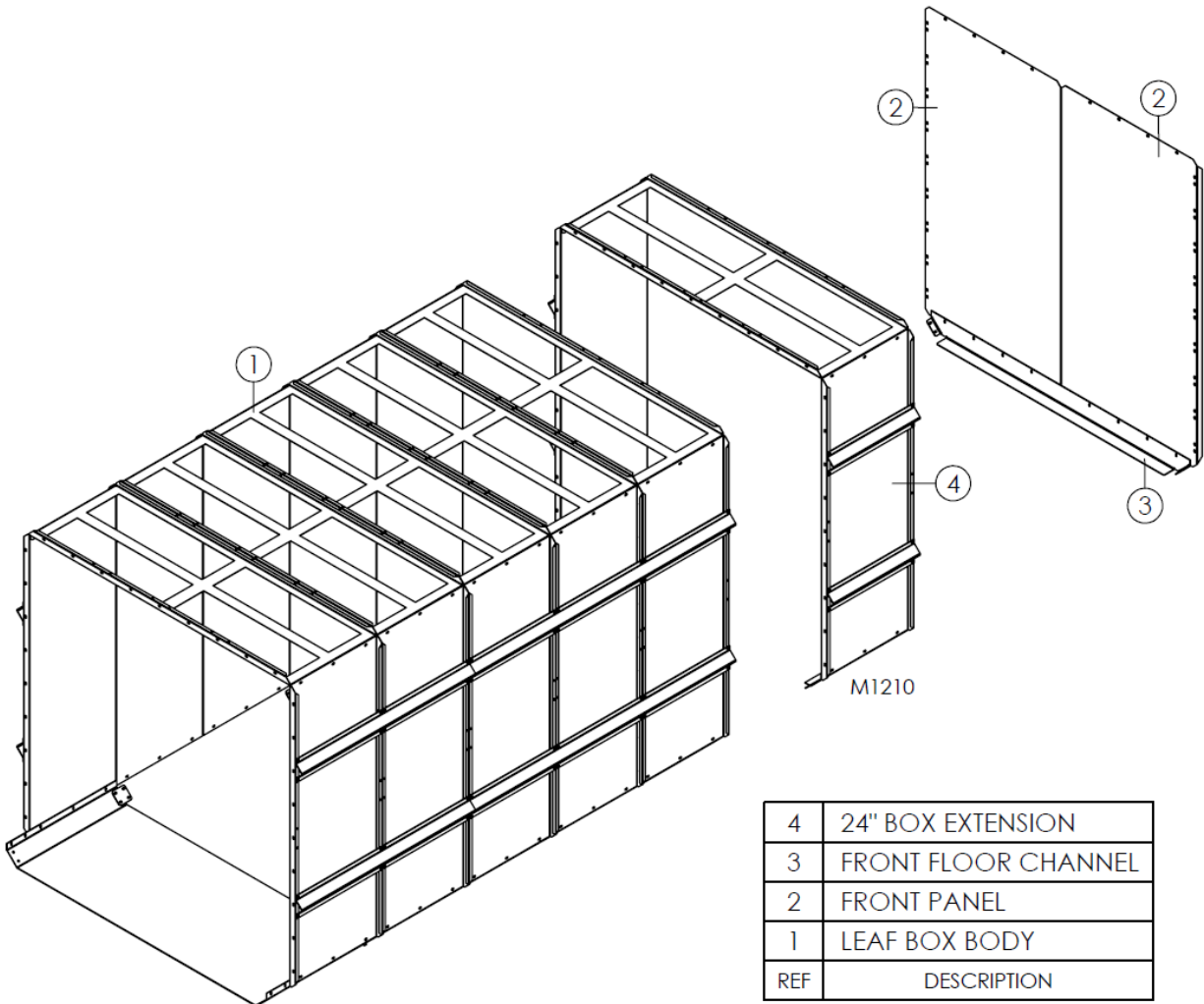


5	R2X7WF0	4	RATCHET STRAP, FLAT HOOK
4	BV3-1157	4	DUMP BODY STRAP HOOK
3	BON-000319SS	16	1/2 -13 NYLON HEX LOCKNUT SS
2	BON-000105SS	16	1/2-13 x 1 HEX BOLT SS
1	BV3-1156	4	MOUNTING BRACKET
REF	PART NO.	QTY	DESCRIPTION

- Position leaf box in dump body. Leaf box should be centered side-to-side with 12" overhang clearance for tailgate dump clearance.
- Locate mounting bracket (1) on side of leaf box. Position so that straps will be vertical after installation.
- Weld -or- bolt dump body bracket (4) on dump body.
- Install ratchet straps (5) orientated as shown.

EXTENSION KIT

The standard leaf box unit is 10 feet long. Extension kits are available that increase the length of the leaf box by 2-foot increments.



- Remove the front panels (2) and front floor channel (3) from the front of the leaf body (1). Leave the front panels and front floor channel bolted together for installation later.
- Align the extension kit (4) with the leaf body and secure with 5/16 NC x 1" flanged hex head screws and 5/16 NC nylon hex locknuts.
- Re-attach the front panels and front floor channel. Leave all bolts loose until all final adjustments are complete

OPERATION

This section of the manual is intended as a supplement to your specific municipal or business guidelines in leaf collection. It is not intended to be a complete leaf collection guide. Training is the key to safe and proper operation of this equipment. Ensure your operation is in compliance with applicable codes and regulations.

- Refer to your leaf vacuum manual for specific instructions pertaining to the operation of that equipment.
- Adjust engine RPM to match working conditions. Generally, lower RPM is better for drier and dustier conditions. It should be noted that engines will have greater vibration at certain RPMs that will vary by engine. As an example, engine vibration may be higher at 2,000 rpm than at 2,200 rpm.
- In some conditions it may be necessary to equip the leaf box with a tarp to assist in additional dust control. Contact Bonnell Industries for assistance and pricing.
- Fill the leaf box as full as much as practical while staying within the GVW of the tow chassis. Ensure compliance with all Federal, State and Local weight restrictions. Note that wet conditions will greatly increase the payload weight of a fully loaded leaf box.
- Disconnect the leaf vacuum from the rear of the host truck. Be sure leaf vacuum is unhitched on level ground. Block the tires to ensure unit is secure. Be observant that the leaf vacuum nozzle clears the tailgate as the host chassis is slowly moved forward.
- To dump the leaf box, remove the snapper pin that locks the tailgate and unlock the door latch. Raise the leaf box making sure all bystanders are a safe distance from the tailgate area.



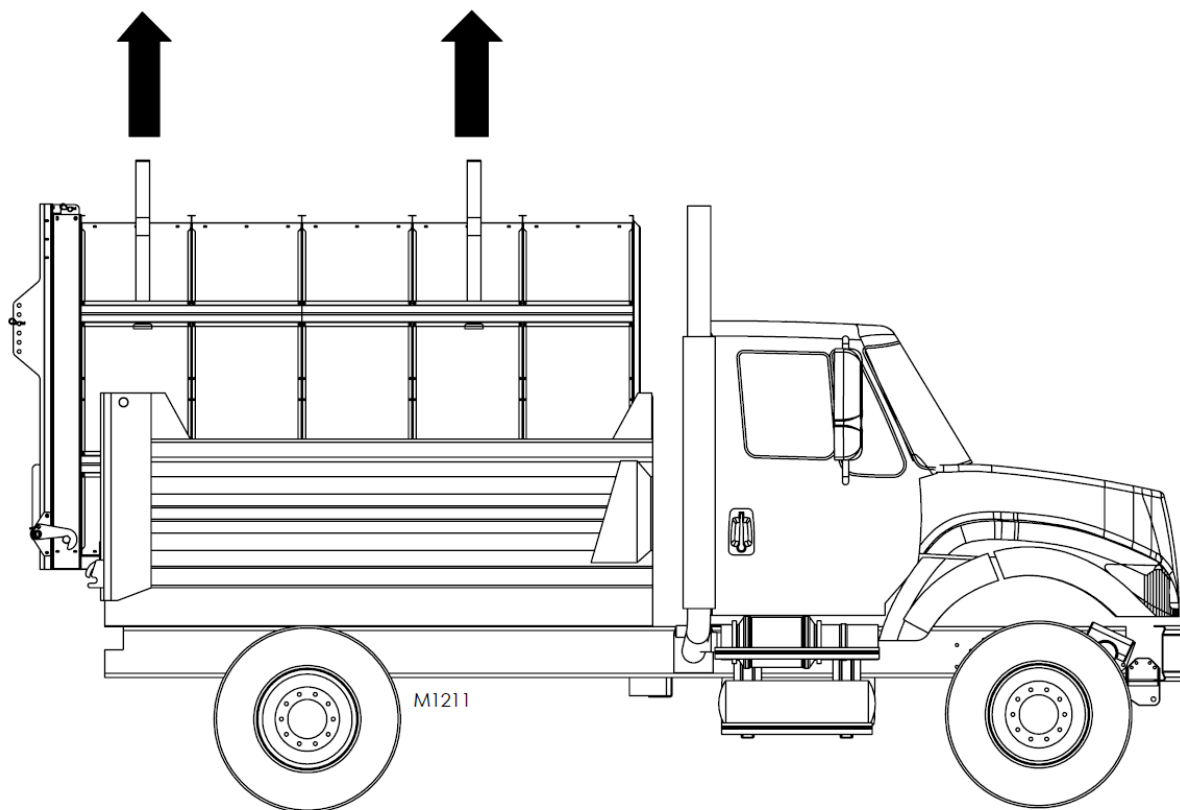
- Evaluate the terrain where the leaf box will dump. Uneven terrain may cause the raised leaf box to become unstable, making it susceptible to tip over.



- As the load dumps, pull forward to clear the load. The tailgate will slide over the spill pile as the unit moves forward.
- Never back up with the body raised. Damage to the open tailgate can occur.
- With the leaf box empty, return the box to transport position. Lock the latch handle in place and secure handle with the snapper pin previously removed.
- Re-attach leaf vacuum to truck chassis. Be sure safety tow chains are secured in place.

STORAGE & MAINTENANCE

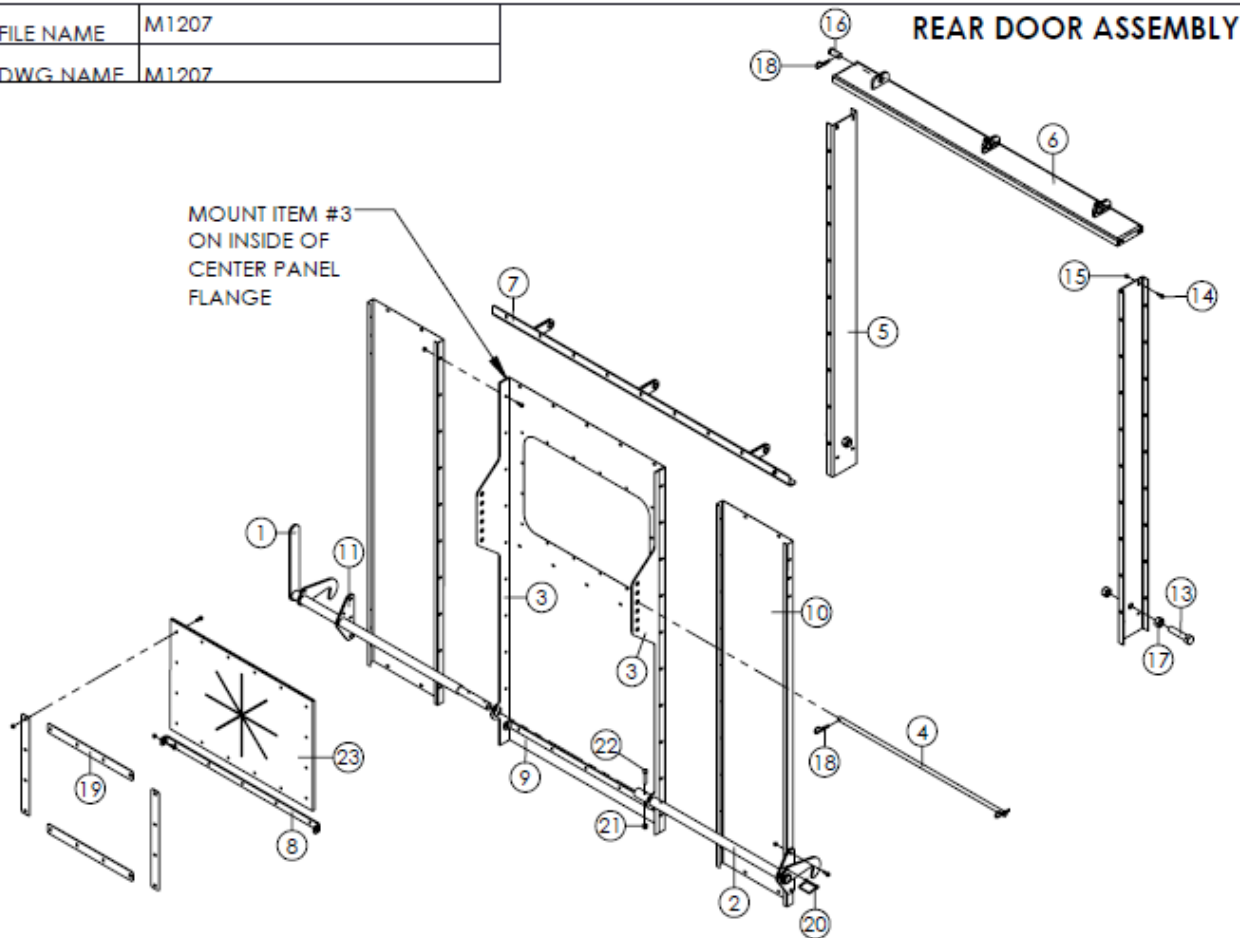
- Remove tie down straps.
- Use suitable lifting chains or straps to securely lift the leaf box off of the truck chassis. Place lifting devices at locations that allow the box to be lifted level. Raise the leaf box as needed to clear the truck floor. Carefully drive the truck out from underneath the suspended leaf box.
- Lower the leaf box close to the ground before transporting it to its storage position.
- Store the leaf box in a suitable location to prevent storage damage. Unit should be placed on blocks to prevent rusting along the bottom edge of the leaf box.
- Perform a post season inspection and repair or replace high service items including the tarp, rubber nozzle flap and any missing hardware.



SERVICE PARTS

FILE NAME	M1207
DWG NAME	M1207

REAR DOOR ASSEMBLY



23	BON-000731	1	RUBBER INSERT
22	BON-000063	2	3/8-16 x 2-1/2 HEX BOLT
21	BON-000319	2	3/8-16 NYLON HEX LOCKNUT
20	BUY-66053	1	SNAPPER PIN - 5/16" x 2-3/4"
19	LV-1964	4	RETAINER STRIP - 10GA x 2" x 21-1/2"
18	BON-000401	5	HAIR PIN - 0.148 x 3"
17	BON-000310	4	1-8 HEX NUT
16	0156794	3	1" DIA x 2" CLEVIS PIN
15	BV2-001651	A/R	5/16-18 SERRATED FLANGE LOCKNUT
14	LV-1959	A/R	5/16-18 x 1" FLANGED HEX HEAD SCREW GR5
13	BON-000239	2	1"-8 x 4-1/2" HEX BOLT GR8 ZP
12			
11	LV-1945	2	MOUNT - TRIP ARM
10	LV-1944	2	PLATE - TAILGATE END PANEL
9	LV-1943	1	PLATE - TAILGATE CENTER PANEL
8	LV-1942	2	WA - TAILGATE CENTER REINFORCEMENT
7	LV-1941	1	WA - TAILGATE HINGE
6	LV-1940	1	WA - TAILGATE HINGE
5	LV-1939	2	WA - TAILGATE CHANNEL
4	LV-1957	1	BAR/RD - 3/4" DIA x 41-1/2"
3	LV-1937	2	WA - REAR VERTICAL STIFFENER
2	LV-1936	1	WA - TRIP ARM, RT
1	LV-1935	1	WA - TRIP ARM, LT
REF	PART NO.	QTY	DESCRIPTION

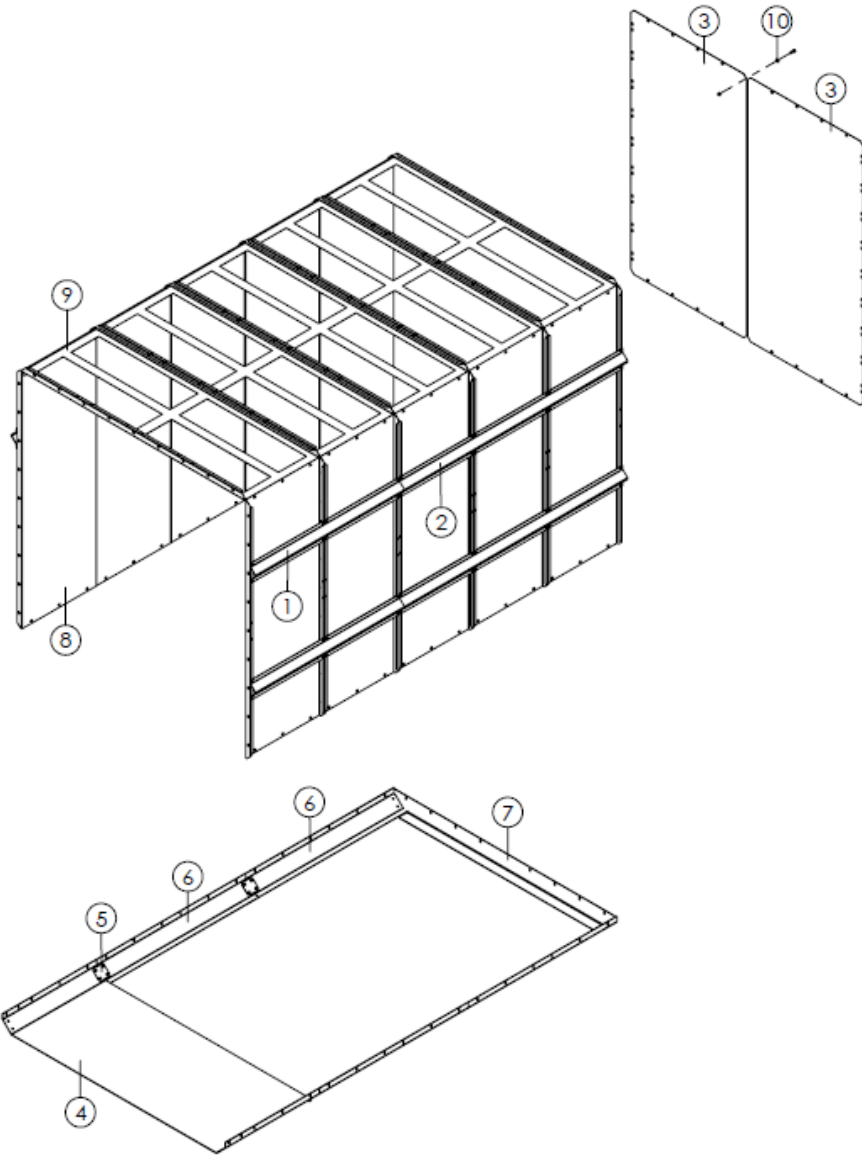
CONFIDENTIAL: THIS DRAWING AND/OR INFORMATION CONTAINED HEREIN IS AND REMAINS THE SOLE PROPERTY OF, AND IS PROPRIETARY TO, BONNELL INDUSTRIES, INC. THIS DRAWING AND/OR INFORMATION SHALL BE KEPT CONFIDENTIAL AND MAY NOT BE REPRODUCED, COPIED, MODIFIED, DISCLOSED, TRANSFERRED, OR MADE AVAILABLE TO OTHERS, EXCEPT WITH THE EXPRESS WRITTEN CONSENT OF BONNELL INDUSTRIES, INC. IT IS LOANED IN CONFIDENCE FOR MUTUAL ASSISTANCE PURPOSES ONLY. BONNELL INDUSTRIES, INC. MAY AT ANY TIME, MODIFY THE DRAWING AND/OR INFORMATION CONTAINED HEREIN.



DIXON, ILLINOIS
PHONE: 800-851-9664

FILE NAME	M1208
DWG NAME	M1208

LEAF BOX BODY



10	BON-000338	1	3/8 STANDARD WASHER
9	LV-1949	5	PANEL - TOP
8	LV-1948	10	PANEL - SIDE
7	LV-1954	1	CHANNEL - FLOOR, FRONT
6	LV-1952	4	CHANNEL - FLOOR, 47-15/16"
5	LV-1953	4	CONNECTOR - FLOOR
4	LV-1946	1	PLATE - FLOOR
3	LV-1947	2	PANEL - FRONT
2	LV-1951	4	REINFORCEMENT - SIDE PANEL, 72"
1	LV-1950	4	REINFORCEMENT - SIDE PANEL, 48"
REF	PART NO.	QTY	DESCRIPTION

CONFIDENTIAL: THIS DRAWING AND/OR INFORMATION CONTAINED HEREIN IS AND REMAINS THE SOLE PROPERTY OF, AND IS PROPRIETARY TO, BONNELL INDUSTRIES, INC. THIS DRAWING AND/OR INFORMATION SHALL BE KEPT CONFIDENTIAL AND MAY NOT BE REPRODUCED, COPIED, MODIFIED, DISCLOSED, TRANSFERRED, OR MADE AVAILABLE TO OTHERS, EXCEPT WITH THE EXPRESS WRITTEN CONSENT OF BONNELL INDUSTRIES, INC. IT IS LOANED IN CONFIDENCE FOR MUTUAL ASSISTANCE PURPOSES ONLY. BONNELL INDUSTRIES, INC. MAY AT ANY TIME, MODIFY THE DRAWING AND/OR INFORMATION CONTAINED HEREIN.

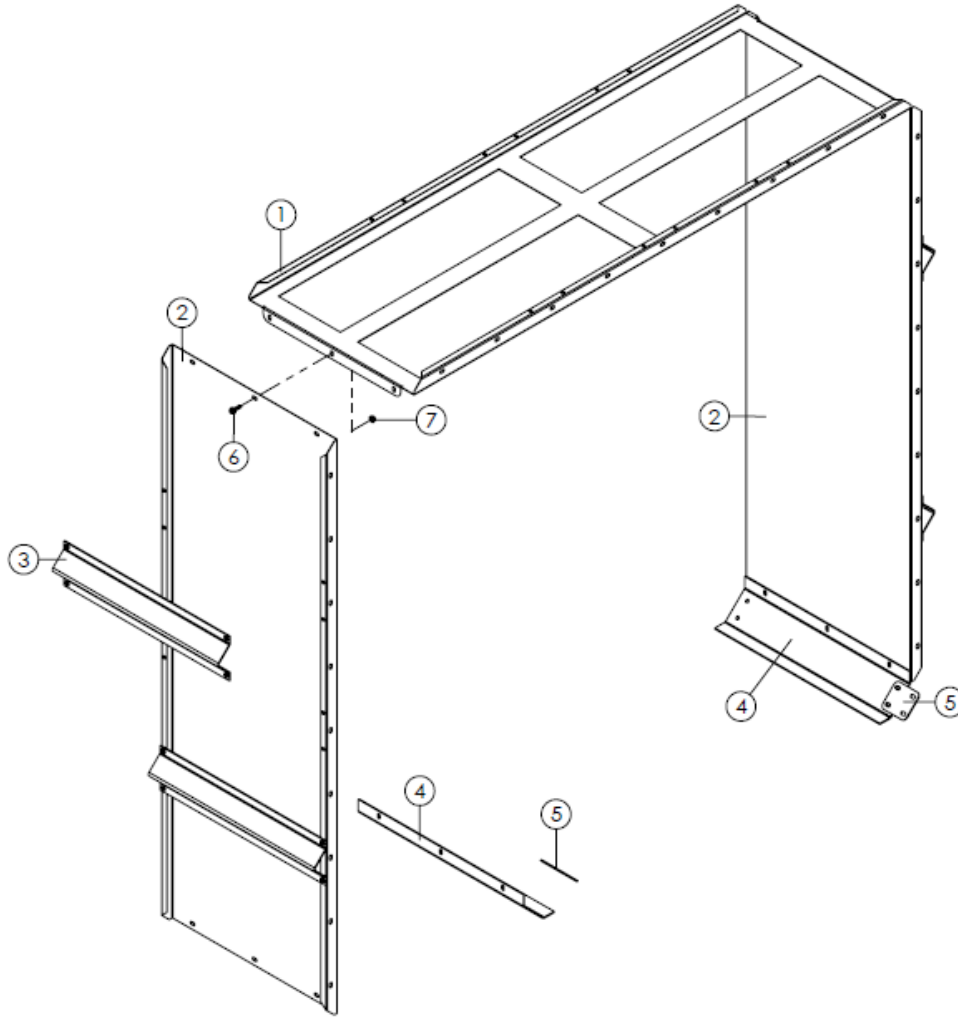
Titan LEAF SOLUTIONS

DIXON, ILLINOIS
PHONE: 800-851-9664

FILE NAME	M1209
DWG NAME	M1209

LEAF BOX EXTENSION KIT

REF LV-1932



7	BV2-001651	59	5/16-18 SERRTED FLANGE LOCKNUT
6	LV-1959	59	5/16-18 x 1" FLANGED HEX HEAD SCREW GR5
5	LV-1953	2	CONNECTOR - FLOOR
4	LV-1963	2	CHANNEL - FLOOR, 23-15/16"
3	LV-1962	4	REINFORCEMENT - SIDE PANEL, 24"
2	LV-1948	2	PANEL - SIDE
1	LV-1949	1	PANEL - SIDE
REV	PART NO	QTY	DESCRIPTION

CONFIDENTIAL: THIS DRAWING AND/OR INFORMATION CONTAINED HEREIN IS AND REMAINS THE SOLE PROPERTY OF, AND IS PROPRIETARY TO, BONNELL INDUSTRIES, INC. THIS DRAWING AND/OR INFORMATION SHALL BE KEPT CONFIDENTIAL AND MAY NOT BE REPRODUCED, COPIED, MODIFIED, DISCLOSED, TRANSFERRED, OR MADE AVAILABLE TO OTHERS, EXCEPT WITH THE EXPRESS WRITTEN CONSENT OF BONNELL INDUSTRIES, INC. IT IS LOANED IN CONFIDENCE FOR MUTUAL ASSISTANCE PURPOSES ONLY. BONNELL INDUSTRIES, INC. MAY AT ANY TIME, MODIFY THE DRAWING AND/OR INFORMATION CONTAINED HEREIN.



DIXON, ILLINOIS
PHONE: 800-851-9664

Bonnell Industries, Inc. warrants to the original purchaser that if any part of the product proves to be defective in workmanship or material within one year of the date of original installation and is returned to us freight prepaid within 30 days after such defect is discovered and notification thereof is provided Bonnell, we will either replace or repair the defective part (our option). This warranty does not apply to damage resulting from neglect, misuse, accident or improper installation or maintenance. Charges for field service, labor, or other expenses not previously authorized and approved in writing by Bonnell Industries, Inc. will not be accepted. This warranty is exclusive and in lieu of all other warranties whether expressed or implied. Bonnell Industries, Inc. neither assumes nor authorizes anyone to assume for it any other obligation or liability in connection with this warranty, and will not be liable for consequential damages. This warranty applies only to products made and/or supplied by Bonnell Industries, Inc. and does not apply to other products not made or supplied by us and to which our products may be attaches, such as trucks. We accept no responsibility for damages to such other products, even if our product is alleged to have contributed to the damage of the other product.

Hydraulic, electrical, or other components furnished by other manufacturers and used with our products are warranted by that manufacturer and not by Bonnell Industries, Inc. the manufacturer's own warranty will apply to these parts. Hydraulic or electrical components are not to be disassembled without the express written permission of Bonnell Industries, Inc.

All defective parts returned from an end user must include the unit model, serial number, date installed, and dealer from whom purchased.

Bonnell Industries, Inc. reserves the right to make changes or improvements to its products without incurring any liability or obligation and without being required to make corresponding changes or improvements to products manufactured or sold prior to those changes or improvements.

The Bonnell Industries, Inc. Warranty Policy is subject to change without notice.

Product Information

When ordering parts, please refer to the information below.

INSTALLATION DATE:

Certificate of Origin

This product was manufactured at Bonnell Industries, Inc.,
located at 1385 Franklin Grove Rd.,
in the city of Dixon, Illinois, U.S.A.

MADE IN THE USA 